

This information is for promotional purposes only. Space considerations may require information to be omitted. Always refer to the actual package for complete label verbiage. This product may not yet be available or approved for sale or use in your area.

IMIDACLOPRID	GROUP	4A	INSECTICIDE
BETA-CYFLUTHRIN	GROUP	3A	INSECTICIDE

# Turonyx™

## ULTRA FX



Contains beta-cyfluthrin and imidacloprid, the active ingredients used in Temprid® FX.

Turonyx™ Ultra FX is not manufactured, or distributed by Bayer Environmental Science, Seller of Temprid® FX.

**In the State of New York, this product may only be applied for indoor uses.**

**In the State of California, this product may only be applied for indoor uses.**

### ACTIVE INGREDIENTS:

(% by weight)

Imidacloprid, 1-[(6-Chloro-3-pyridinyl)methyl]-*N*-nitro-2-imidazolidinimine ..... 21.0%

Beta-Cyfluthrin, Cyano(4-fluoro-3-phenoxyphenyl)methyl 3-(2,2-dichloroethyl)-2,2-dimethyl-cyclopropanecarboxylate ..... 10.5%

**OTHER INGREDIENTS:** ..... 68.5%

**TOTAL** ..... 100.0%

Contains 2 lbs of imidacloprid and 1 lb of beta-cyfluthrin per gallon.

EPA Reg. No.: 91234-297

## KEEP OUT OF REACH OF CHILDREN

# CAUTION

Si usted no entiende la etiqueta, busque a alguien para que se la explique a usted en detalle.

(If you do not understand the label, find someone to explain it to you in detail.)

See below for additional Precautionary Statements.

FIRST AID	
<b>If swallowed:</b>	<ul style="list-style-type: none"> <li>Call a poison control center or doctor immediately for treatment advice.</li> <li>Have person sip a glass of water if able to swallow.</li> <li><b>DO NOT</b> induce vomiting unless told to do so by the poison control center or doctor.</li> <li><b>DO NOT</b> give anything by mouth to an unconscious person.</li> </ul>
<b>If on skin or clothing:</b>	<ul style="list-style-type: none"> <li>Take off contaminated clothing.</li> <li>Rinse skin immediately with plenty of water for 15-20 minutes.</li> <li>Call a poison control center or doctor for treatment advice.</li> </ul>
<b>If in eyes:</b>	<ul style="list-style-type: none"> <li>Hold eye open and rinse slowly and gently with water for 15-20 minutes.</li> <li>Remove contact lenses, if present, after the first 5 minutes, then continue rinsing eye.</li> <li>Call a poison control center or doctor for treatment advice.</li> </ul>
HOT LINE NUMBER	
Have the product container or label with you when calling a poison control center or doctor, or going for treatment. You may also contact SafetyCall at 1-844-685-9173 for emergency medical treatment information.	
<b>Note To Physician:</b> No specific antidote is available. Treat the patient symptomatically.	

**For Chemical Emergency: Spill, Leak, Fire, Exposure, or Accident, Call CHEMTREC Day or Night Within USA and Canada: 1-800-424-9300 or +1 703-527-3887 (collect calls accepted)**



## PRECAUTIONARY STATEMENTS

### HAZARDS TO HUMANS AND DOMESTIC ANIMALS

#### CAUTION

Harmful if absorbed through skin. Harmful if swallowed. Causes moderate eye irritation. Avoid contact with skin, eyes, or clothing. Wash thoroughly with soap and water after handling and before eating, drinking, chewing gum, or using tobacco. Remove contaminated clothing and wash before reuse.

#### Personal Protection Equipment (PPE):

- Wear long-sleeved shirt and long pants,
- Socks and shoes,
- Gloves made of any waterproof material.

#### ENVIRONMENTAL HAZARDS

This pesticide is extremely toxic to wildlife, fish, and aquatic invertebrates. Drift and run-off from treated areas may be hazardous to aquatic organisms in neighboring areas. Care should be used when spraying to avoid fish and reptile pets in/around ornamental ponds. This product is highly toxic to bees exposed to direct treatment or residues on blooming crops/plants or weeds. **DO NOT** apply this product or allow it to drift to blooming crops/plants or weeds if bees are foraging the treatment area.

To protect the environment, **DO NOT** allow pesticide to enter or run off into storm drains, drainage ditches, gutters, or surface waters. Applying this product in calm weather when rain is not predicted for the next 24 hours will help to ensure that wind or rain does not blow or wash pesticide off the treatment area. Rinsing application equipment over the treated area will help avoid runoff to water bodies or drainage systems.

#### PHYSICAL OR CHEMICAL HAZARDS

**DO NOT** mix or allow coming in contact with Oxidizing agents.

Hazardous Chemical reaction may occur.

### PROTECTION OF POLLINATORS



**APPLICATION RESTRICTIONS** EXIST FOR THIS PRODUCT BECAUSE OF RISK TO BEES AND OTHER INSECT POLLINATORS. FOLLOW APPLICATION RESTRICTIONS FOUND IN THE DIRECTIONS FOR USE TO PROTECT POLLINATORS.

Look for the bee hazard icon  in the Directions for Use for each application site for specific use restrictions and instructions to protect bees and other insect pollinators.

**This product can kill bees and other insect pollinators.**

Bees and other insect pollinators will forage on plants when they flower, shed pollen, or produce nectar.

Bees and other insect pollinators can be exposed to this pesticide from:

- Direct contact during foliar applications, or contact with residues on plant surfaces after foliar applications.
- Ingestion of residues in nectar and pollen when the pesticide is applied as a seed treatment, soil, tree injection, as well as foliar applications.

When Using This Product Take Steps To:

- Minimize exposure of this product to bees and other insect pollinators when they are foraging on pollinator attractive plants around the application site.
- Minimize drift of this product on to beehives or to off-site pollinator attractive habitat. Drift of this product onto beehives or off-site to pollinator attractive habitat can result in bee kills.

Information on protecting bees and other insect pollinators may be found at the Pesticide Environmental Stewardship website at:

<http://pesticidestewardship.org/PollinatorProtection/Pages/default.aspx>.

Pesticide incidents (for example, bee kills) should immediately be reported to the state/tribal lead agency. For contact information for your state, go to:

[www.aapco.org/officials.html](http://www.aapco.org/officials.html). Pesticide incidents should also be reported to the National Pesticide Information Center at:

[www.npic.orst.edu](http://www.npic.orst.edu) or directly to EPA at: [beekill@epa.gov](mailto:beekill@epa.gov)

### DIRECTIONS FOR USE



It is a violation of Federal law to use this product in a manner inconsistent with its labeling.



For both indoor and outdoor\* use.

**DO NOT** apply Turonyx Ultra FX while bees are foraging. **DO NOT** apply Turonyx Ultra FX to plants that are flowering. Only apply after all flower petals have fallen off.

\*Not Registered for Use in California

## PRODUCT FACTS

- Two modes of action
- Contact activity & systemic action
- Low odor
- Non-staining

<b>Turonyx Ultra FX</b>	<ul style="list-style-type: none"> <li>▪ <b>Turonyx Ultra FX</b> is a suspension concentrate formulation of two insecticide active ingredients, Imidacloprid and Beta-Cyfluthrin. One gallon of this product contains 2 lbs of Imidacloprid and 1 lb of Beta-Cyfluthrin.</li> <li>▪ Shake well before using.</li> </ul>
<b>Controls</b>	<ul style="list-style-type: none"> <li>▪ Indoor / General Household Pests<sup>†</sup></li> <li>▪ Outdoor / Perimeter Pests<sup>*,†</sup></li> <li>▪ Wood-Infesting Pests<sup>†</sup></li> </ul> <p><sup>†</sup>For list of specific insects, see inside.</p>
<b>Where To Apply</b>	<p>Apply where pests have been seen or found, or can find shelter.</p> <ul style="list-style-type: none"> <li>▪ In and around* buildings and structures.</li> <li>▪ On established landscape ornamentals that are not in bloom* around residential and commercial properties.</li> </ul>
<b>Dilution Rates</b>	<ul style="list-style-type: none"> <li>▪ When 0.27 fl oz (8 milliliters) is diluted in one gal of water, the combined active ingredient concentration (0.075%) contains 0.05% Imidacloprid and 0.025% Beta-Cyfluthrin (0.004 lb. imidacloprid and 0.002 lb. beta-cyfluthrin).</li> <li>▪ When 0.54 fl oz (16 milliliters) is diluted in one gal of water, the combined active ingredient concentration (0.15%) contains 0.10% Imidacloprid and 0.05% Beta-Cyfluthrin (0.008 lb. imidacloprid and 0.004 lb. beta-cyfluthrin).</li> </ul>
<b>Mixing Information</b>	<ul style="list-style-type: none"> <li>▪ Mix the appropriate amount of <b>Turonyx Ultra FX</b> with water.</li> <li>▪ Add product when filling spray tank with water; shake or agitate mixture.</li> <li>▪ Diluted spray mixture can be stored overnight. Agitate before using.</li> </ul>
<b>How To Apply</b>	<ul style="list-style-type: none"> <li>▪ General surface (outdoors only)*, spot treatment, and void injections by mist, foam, or crack and crevice sprays.</li> <li>▪ Foliar application to established landscape ornamentals that are not in bloom*.</li> </ul>
<b>Re-Apply</b>	<ul style="list-style-type: none"> <li>▪ Every 7 to 10 days, if needed.</li> </ul>
<b>Application Restrictions</b>	<ul style="list-style-type: none"> <li>▪ At the 0.27 fl oz. (8 milliliter) (0.004 lb. imidacloprid and 0.002 lb. beta-cyfluthrin per acre) per gallon use rate, this is a limit of 118 dilute gallons per acre, per year and at the 0.54 fl oz. (16 milliliter) (0.008 lb. imidacloprid and 0.004 lb. beta-cyfluthrin per acre) per gallon use rate this is a limit of 59 dilute gallons per acre, per year for landscape, lawn, and ornamental applications.</li> <li>▪ <b>DO NOT</b> apply more than 32.0 fluid ounces of <b>Turonyx Ultra FX</b> per acre, per year. (Equal to maximum annual use of 0.5 pounds of Imidacloprid and 0.25 pounds of Beta-cyfluthrin per acre, per year).</li> <li>▪ <b>DO NOT</b> apply more than 0.54 fl. oz. (16 milliliter) (0.008 lb. imidacloprid and 0.004 lb. beta-cyfluthrin per acre) of <b>Turonyx Ultra FX</b> per single application.</li> </ul>
<b>Re-Entry</b> 	<ul style="list-style-type: none"> <li>▪ <b>DO NOT</b> contact treated surfaces until dry.</li> <li>▪ People and pets may re-enter after the treated area is dry.</li> </ul>
	<ul style="list-style-type: none"> <li>▪ <b>DO NOT</b> allow to enter indoor or outdoor drains.</li> </ul> <p><i>No permita la entrada a desagües internos o externos.</i></p>
<b>Questions</b> 	<p>For questions or comments, call 984-465-4800.</p>

\*Not Registered for Use in California

### INDOOR PESTS

#### FOR RESIDUAL PEST CONTROL IN BUILDINGS, STRUCTURES, AND MODES OF TRANSPORT

Use **Turonyx Ultra FX** as a spot spray or crack and crevice treatment inside buildings and structures (schools, factories, stores, warehouses, hospitals, food processing facilities (non food/feed areas), modes of transport). For a list of common facilities where this product may be used, see Appendix.

Ants	Crickets	Hide beetles	Phorid flies
Bed bugs	Darkling beetles	Hornets	Pill bugs
Blue or Green Bottle flies	Dermestids	House flies	Sciarid flies (fungus gnats)
Boxelder bugs	Earwigs	Kudzu (globular stink) bugs	Silverfish
Brown marmorated stink bugs	Elm leaf beetles	Leather beetles	Sow bugs
Carpet beetles	Elm seed bugs	Midges	Spiders
Centipedes	Firebrats	Millipedes	Wasps
Clothes moths	Flesh flies	Moths	Western conifer seed bugs
Clover mites	Flies	Multicolored Asian lady beetles	Yellow jackets
Cluster flies	Fruit flies		
Cockroaches	Gnats		

(continued)



<b>INDOOR PESTS (cont.)</b>	
<b>Where To Apply</b>	<ul style="list-style-type: none"> <li>▪ Treat where pests have been seen or found, or can find shelter.</li> <li>▪ Use <b>only</b> as a spot spray or crack and crevice or void treatments inside buildings and structures.</li> <li>▪ Treat entry points, such as around water pipes, doors, windows, and eaves.</li> <li>▪ Treat areas where pests normally feed or hide (baseboards, corners, around water pipes, behind or under refrigerators, cabinets, sinks, stoves).</li> <li>▪ Mist or foam applications can be made behind veneers, piers, and chimney bases, into rubble foundations, into block voids or structural voids, wall voids, under slabs, stoops, porches, or to the soil in crawlspaces, and other similar voids.</li> <li>▪ Spot treat floor or rugs beneath furniture, in closets, and storage areas, but <b>DO NOT</b> apply to entire floor area. Spot treatments must not exceed two square feet in size (for example, 2 ft. by 1 ft. or 4 ft. by 0.5 ft.)</li> </ul>
<b>Use Rate</b>	<ul style="list-style-type: none"> <li>▪ 0.075% - - 0.27 fl oz (8 milliliters) (0.004 lb. imidacloprid and 0.002 lb. beta-cyfluthrin) per gallon of water.</li> <li>▪ 0.15% - - 0.54 fl oz (16 milliliters) (0.008 lb. imidacloprid and 0.004 lb. beta-cyfluthrin) per gallon of water, or 0.27 fl oz (8 ml) per half gallon of water.</li> <li>▪ Except for bed bugs, use the higher labeled rate for severe infestations, fast knockdown, and long residual.</li> <li>▪ For bed bugs, <b>DO NOT</b> exceed an application rate of 0.075% - 0.27 fl oz (8 milliliters) (0.004 lb. imidacloprid and 0.002 lb. beta-cyfluthrin) of <b>Turonyx Ultra FX</b> per gal of water.</li> </ul>
<b>How to Apply</b>	<ul style="list-style-type: none"> <li>▪ Remove or tightly cover fish tanks and disconnect aerators during application.</li> <li>▪ Keep people and pets away from sites of application until treated surfaces are completely dry.</li> <li>▪ <b>DO NOT</b> contact treated surfaces until dry.</li> <li>▪ When treating areas over your head, wear eye protection (safety glasses, goggles, or face shield) and dust mask or particulate respirator.</li> </ul> <p><b>Spot Applications:</b></p> <ul style="list-style-type: none"> <li>▪ Use a low-pressure system (<b>DO NOT</b> exceed 50 psi at nozzle tip) with a fan-type nozzle to apply the dilution uniformly. Spot treatments must not exceed two square feet in size (for example, 2 ft. by 1 ft. or 4 ft. by 0.5 ft.).</li> <li>▪ In the home, cover all food processing surfaces and utensils or thoroughly wash following treatment. Cover exposed food or remove from area being treated.</li> </ul> <p><b>Spray, Mist, or Foam Crack and Crevice or Void Applications:</b></p> <ul style="list-style-type: none"> <li>▪ Spray, mist or foam directly into cracks and crevices or voids where pests or their nests are present. Apply the volume of spray, mist, or foam sufficient to cover the area. Treat surfaces to ensure thorough coverage but avoid runoff. To treat insects harbored in voids and cracks-and-crevices, applications must be made in such a manner to limit dripping and avoid runoff onto untreated structural surfaces and plants.</li> <li>▪ <b>Spray:</b> Use a low-pressure system (<b>DO NOT</b> exceed 50 psi at nozzle tip) with a pinpoint or variable pattern nozzle, or applicator equipment that delivers low volume treatments.</li> <li>▪ <b>Mist:</b> Use appropriate mist generating equipment, <b>DO NOT</b> allow mist to drift out of void spaces into commonly occupied areas of the structure.</li> <li>▪ <b>Foam:</b> Use appropriate foam generating equipment to supply a sufficient volume of foam. Mix the dilution with manufacturer's specified volume of foaming agent.</li> </ul>
<b>When To Apply</b>	<ul style="list-style-type: none"> <li>▪ When pests are seen or found.</li> <li>▪ Re-apply every 7 to 10 days if needed.</li> </ul>
<b>Application Restrictions</b>	<ul style="list-style-type: none"> <li>▪ <b>DO NOT</b> apply in food/feed areas of food and feed handling establishments.</li> <li>▪ <b>DO NOT</b> apply broadcast treatments to floors or floor coverings.</li> <li>▪ <b>DO NOT</b> apply in hospital and/or nursing home rooms while they are occupied.</li> <li>▪ <b>DO NOT</b> apply in classrooms while they are occupied.</li> <li>▪ <b>DO NOT</b> apply as a space spray.</li> <li>▪ <b>DO NOT</b> allow excessive dripping or run-off to occur from vertical or overhead surfaces.</li> <li>▪ <b>DO NOT</b> apply where electrical short circuits can occur; use a dust or dry bait in these areas.</li> <li>▪ <b>DO NOT</b> apply to furniture or upholstery where prolonged contact with humans will occur.</li> <li>▪ <b>DO NOT</b> spray bed linens or other materials which come in direct contact with occupants of the bed.</li> <li>▪ <b>DO NOT</b> apply more than 5 gallons of diluted product indoors per individual applicator per day.</li> <li>▪ <b>DO NOT</b> apply more than 0.54 fl oz. (16 milliliters) (0.008 lb. imidacloprid and 0.004 lb. beta-cyfluthrin) of <b>Turonyx Ultra FX</b> per single application.</li> </ul>
<b>APPLICATION INSTRUCTIONS FOR INDOOR PESTS</b>	
<b>Crawling Insects</b> Cockroaches, Crickets, Silverfish, Spiders, and other listed pests	<p>Use a coarse, low-pressure spray. <b>DO NOT</b> exceed 50 psi at nozzle tip.</p> <p>Treat entry points (around water pipes, doors, windows, eaves). Treat areas where pests normally feed or hide (baseboards, corners, around water pipes, under refrigerators, cabinets, sinks, stoves), being sure to spray cracks and crevices. Spot treat floor or rugs beneath furniture, in closets, and storage areas, but <b>DO NOT</b> apply to entire floor area.</p> <p>For more difficult to control pests, direct contact spray is required for effective control.</p>

(continued)

APPLICATION INSTRUCTIONS FOR INDOOR PESTS (cont.)	
<b>Bed bugs</b>	<p><b>Use Rate:</b> 0.075% - 0.27 fl oz (8 milliliters) (0.004 lb. imidacloprid and 0.002 lb. beta-cyfluthrin) of <b>Turonyx Ultra FX</b> per gal of water.</p> <p>Controls bed bug populations that are resistant to pyrethroid insecticides. Efficacy of this product is not affected by heat treatments, so applications can be made before heat treatments in integrated bed bug elimination programs. Spray bugs and eggs directly wherever possible following site directions below. Bed bug eggs that are directly treated with this product are killed outright, and young nymphs that emerge from eggs are killed by dried residues.</p> <p>For infested mattresses, remove linens and wash before reuse. Apply to tufts, seams, folds, and edges until moist. Allow to dry before remaking bed. Apply to bedsprings, box springs, and the interior of bed frames or headboards, including all cracks and joints.</p> <p>When bed bugs are found in upholstered furniture, apply only to the infested tufts, seams, folds, and edges, but <b>DO NOT</b> apply to flat surfaces where prolonged human contact will occur. If bugs heavily infest furniture (inside cushions and/or batting), apply a labeled insecticide dust or consider fumigation.</p> <p>Apply as a crack and crevice treatment to all baseboards, moldings, beneath floor coverings and carpets, closets, shelves, curtains, furniture and picture frames that may provide harborage to bed bugs.</p> <p>Inside empty luggage, apply to seams, folds and edges until moist; remove all clothes and other articles from luggage before application and allow treated areas to thoroughly dry before use.</p> <p>Re-apply every 7 to 10 days, as needed, until infestation is eliminated.</p>
<b>Ants</b>	<p>Apply to ant trails on walls, tile, baseboards, around pipes, under cabinets, and places where ants are active.</p> <p>Treat entry points like windows and doors, or sites where utilities enter the structure; also see directions for use in <b>Outdoor/Perimeter Pests</b> section.</p> <p>Treat nests when possible.</p>
<b>Listed Flying Insects</b>	Apply to surfaces where these pests congregate, collect, or rest.

OUTDOOR/PERIMETER PESTS*				
Ants	Crickets	Gnats	Moths	Sow bugs
Blue or Green Bottle flies	Earwigs	Ground beetles	Mosquitoes	Spiders
Boxelder bugs	Elm leaf beetles	Hornets	Multicolored Asian lady beetles	Springtails
Brown marmorated stink bugs	Elm seed bugs	House flies	Pill bugs	Stable flies
Carpenter ants	Fire ants	Kudzu (globular stink) bugs	Scorpions	Ticks
Centipedes	Firebrats	Midges	Silverfish	Wasps
Cockroaches	Fleas	Millipedes		Western conifer seed bugs
Cluster flies	Flesh flies			Yellow jackets
Clover mites	Flies			
<b>Where To Apply</b>	<ul style="list-style-type: none"> <li>Apply to surfaces on buildings, porches, patios, around doors and windows, eaves and attic vents, utility entry points, soffit areas, and other exterior openings (foundation cracks or drilled holes) where these pests enter the structure or where they have been seen or found, or can find shelter.</li> <li>To prevent or to control infestations outdoors, treat the outside of the structure, to include walls to a height of 2 feet, around doors, windows, and soffits where pests are active or may enter or hide. Treat the soil, turf, or other non-flowering ground covering adjacent to the structure, in a band up to 7 feet wide, and wherever pests are seen, have been found, or can find shelter.</li> <li>In ant management programs, apply to shrubs or ornamental plant beds that are not blooming, and where ants may find food or forage.</li> <li>In mosquito and occasional invader management programs, apply to trees, shrubs, or ornamental plant beds that are not blooming.</li> <li>In flea and tick management programs, apply along paths, tall grass, and other vegetation that is not blooming.</li> <li>To control listed stinging insects, treat nests and/or mounds wherever they occur.</li> </ul>			
<b>Use Rate</b>	<ul style="list-style-type: none"> <li>0.075% - 0.27 fl oz (8 milliliters) (0.184 lb. imidacloprid and 0.092 lb. beta-cyfluthrin) per 1,000 sq ft of surface.</li> <li>0.15% - 0.54 fl oz (16 milliliters) (0.368 lb. imidacloprid and 0.184 lb. beta-cyfluthrin) per 1,000 sq ft of surface, or 0.27 fl oz (8 ml) per 500 sq ft of surface.</li> <li>Always use the 0.15% rate for fire ants, hornets, wasps and yellow jackets.</li> </ul>			
<b>How To Apply</b> (also see Application Instructions For Outdoor / Perimeter Pests)	<p><b>High volume applications using power sprayers:</b> In power sprayers, adjust the rate of product dilution to apply 8 to 16 milliliters (0.184 - 0.368 lb. imidacloprid and 0.002 - 0.184 beta-cyfluthrin) of <b>Turonyx Ultra FX</b> per 1,000 square feet in sufficient water to provide adequate coverage. For example, mixing 4.5 fluid ounces (133 milliliters) of this product in a 50 gallon tank, when applied in a volume of 3.0 gallons per 1,000 square feet, will apply 0.27 fluid ounces (0.184 lb. imidacloprid and 0.002 lb. beta-cyfluthrin) of this product per 1,000 square feet. The table below gives examples of end use dilutions for typical power spraying application volumes:</p>			

(continued)

(continued)



**OUTDOOR/PERIMETER PESTS\* (cont.)****How To Apply**

(also see Application Instructions For  
Outdoor / Perimeter Pests)

(cont.)

**DILUTION RATE CHART**

Amount of Product fluid ounces (milliliters)	Application Volume gallons water	Concentration (% AI) In spray solution	Pounds AI
0.27 (8)	1	0.075%	0.004 lb. imidacloprid 0.002 lb. beta-cyfluthrin
	2	0.038%	
	3	0.025%	
	4	0.019%	
	5	0.015%	
0.54 (16)	1	0.150%	0.008 lb. imidacloprid 0.004 lb. beta-cyfluthrin
	2	0.075%	
	3	0.050%	
	4	0.038%	
	5	0.030%	

Apply enough dilution to adequately cover the area without excessive dripping or run-off. Volume can vary depending on the surface type treated. For example, mulch requires more spray than bare soil. **DO NOT** contact treated surfaces until dry.

**When To Apply**

- When pests are seen or found.
- Re-apply every 7 to 10 days if needed, not to exceed maximum labeled rate per calendar year.
- **DO NOT** allow this product to contact plants in bloom.
- At the 8 milliliter (0.004 lb. imidacloprid and 0.002 lb. beta-cyfluthrin) per gallon use rate, this is a limit of 118 dilute gallons per acre, per year and at the 16 milliliter per gallon use rate, this is a limit of 59 dilute gallons per acre, per year for landscape, lawn, and ornamental applications.

**Application Restrictions**

- **DO NOT** apply more than 32.0 fluid ounces of **Turonyx Ultra FX** per acre, per year. (Maximum annual use of 0.5 pounds of imidacloprid and 0.25 pounds of β-cyfluthrin per acre, per year.)
- **DO NOT** apply more than 0.54 fl oz. (16 milliliters) (0.008 lb. imidacloprid and 0.004 lb. beta-cyfluthrin) of **Turonyx Ultra FX** per single application.
- **DO NOT** make more than 2 applications at the minimum application rate of 0.27 fl oz. (8 milliliters) (0.004 lb. imidacloprid and 0.002 lb. beta-cyfluthrin) per year.
- All outdoor spray applications must be limited to spot or crack-and-crevice treatments only, except for the following permitted uses:
  1. Application to pervious surfaces such as soil, lawn, turf, and other vegetation;
  2. Perimeter band treatments of 7 feet wide or less from the base of a man-made structure to pervious surfaces (e.g., soil, mulch, or lawn);
  3. Applications to underside of eaves, soffits, doors, or windows permanently protected from rainfall by a covering, overhang, awning, or other structure;
  4. Applications around potential exterior pest entry points into man-made structures such as doorways and windows, when limited to a band not to exceed one inch;
  5. Applications to vertical surfaces (such as the side of a man-made structure) directly above impervious surfaces (e.g., driveways, sidewalks, etc.), up to 2 feet above ground level;
  6. Applications to vertical surfaces directly above pervious surfaces, such as soil, lawn, turf, mulch or other vegetation) only if the pervious surface does not drain into ditches, storm drains, gutters, or surface waters.
- Treat surfaces to ensure thorough coverage but avoid runoff.
- To treat insects harbored in voids and cracks-and-crevices, applications must be made in such a manner to limit dripping and avoid runoff onto untreated structural surfaces and plants.
- For soil or foliar applications, **DO NOT** apply by ground within 25 feet of lakes, reservoirs, rivers, permanent streams, marshes or natural ponds, estuaries and commercial fish farm ponds.
- **DO NOT** spray the product into fish pools, ponds, streams, or lakes. **DO NOT** apply directly to sewers or storm drains, or to any area like a drain or gutter where drainage to sewers, storm drains, water bodies, or aquatic habitat can occur.
- **DO NOT** allow the product to enter any drain during or after application.
- **DO NOT** apply directly to impervious horizontal surfaces such as sidewalks, driveways, and patios except as a spot or crack-and-crevice treatment.
- **DO NOT** apply or irrigate to the point of runoff.
- **DO NOT** make applications during rain. Avoid making applications when rainfall is expected before the product has sufficient time to dry (minimum 4 hours).
- Rainfall within 24 hours after application may cause unintended runoff of pesticide application.
- Spot treatments must not exceed two square feet in size (for example, 2 ft. by 1 ft. or 4 ft. by 0.5 ft.).
- **DO NOT** allow this product to contact plants in bloom.
- **DO NOT** apply this product, by any application method, to linden, basswood, or other *Tilia* species.
- **DO NOT** apply when the wind speed is greater than 15 mph.

\*Not Registered for Use in California



Manufactured for:

**Atticus, LLC**

940 NW Cary Parkway, Suite 200

Cary, NC 27513

APPLICATION INSTRUCTIONS FOR OUTDOOR/PERIMETER PESTS*	
<b>Ants</b>	<p>Locate and treat ant nests if possible. Follow trails of foraging workers, check under objects near the structure, and inspect other likely nest sites. If ants are nesting in the soil, thoroughly drench or inject the nest and surrounding soil. Treat ant trails around windows and doors, along sidewalks, or other areas where seen. Apply a perimeter treatment as described above.</p> <p><b>Turonyx Ultra FX</b> contains a systemic insecticide (Imidacloprid), so foliar application to landscape ornamentals provides locally systemic control of aphids, scale insects, and other plant-sucking insects and limits the production of honeydew (an important food source for ant populations).</p> <p>Apply a very light mist of the dilute spray, and <b>DO NOT</b> allow excess run-off. Treat thoroughly for good coverage, including the underside of leaves, as these pests often feed or rest there.</p> <p><b>Aerial Nests:</b> If ant nests are located in tree hollows or non-structural wooden construction (e.g.; posts, fences, decks) treat the interior cavity and/or the nest site by injecting a spray, mist, or sufficient volume of foam.</p> <p>It is recommended to remove or prune away any shrubbery, bushes, and tree branches touching the structure. Vegetation touching the structure may offer a route of entry for ants into the structure. This may allow ants to inhabit the structure without coming in contact with the treatment.</p>
<b>Hornets, wasps, and yellow jackets</b>	<p><b>Use Rate:</b> 0.15% - - 0.54 fl oz (16 milliliters) (0.008 lb. imidacloprid and 0.004 lb. beta-cyfluthrin) of <b>Turonyx Ultra FX</b> per gal of water, or 0.27 fl oz (8 ml) per half gallon of water.</p> <p>Make pin stream applications directly to the nests. To help avoid stings treat nests in the evening when the insects are inside the nest. Remove and destroy treated nests to prevent emergence of newly hatched insects. If removal is not possible, retreat nests if necessary.</p>
<b>Occasional invaders</b> Boxelder bugs, elm leaf beetle, seed bugs, stink bugs, and other listed pests	<p>Apply directly to insects that have congregated around doors and windows and similar areas where they may enter structures. Apply perimeter treatment as described above.</p> <p>For best results, treat infested trees and shrubs early in the season. A single foliar application of this product will kill stink bugs feeding on protected plants for 4 weeks. Tree spraying may require ornamental license – check with your local regulator.</p>
<b>Centipedes, earwigs, millipedes, pill bugs, sow bugs, springtails</b>	<p>Apply perimeter treatment to reduce the number of insects from entering the structure. Thoroughly treat mulched areas.</p> <p>Correcting moisture problems around the structure will reduce pest pressure.</p>
<b>Fire Ants</b>	<p><b>Use Rate:</b> 0.15% - - 0.54 fl oz (16 milliliters) (0.008 lb. imidacloprid and 0.004 lb. beta-cyfluthrin) of <b>Turonyx Ultra FX</b> per gal of water, or 0.27 fl oz (8 ml) per half gallon of water.</p> <p>Thoroughly drench or inject the entire mound. When using injection treatment, you must treat the bottom of the mound. Apply dilution or foam using a downward and upward motion of the injector tool. For complete distribution, inject in several points throughout the mound.</p> <p>Treat new mounds as they appear.</p> <ul style="list-style-type: none"> <li><b>DO NOT</b> use in pastures or areas of food crop production.</li> </ul>
<b>Fleas &amp; ticks</b> (Ticks that may transmit Lyme Disease and Rocky Mountain Spotted fever)	<p>For ticks, treat likely harborage areas like along paths, tall grass, and other vegetation. For fleas, concentrate treatments in areas where pets are known to rest, as these areas are larval breeding hot spots.</p> <p>One application will kill adult fleas for 2 to 3 months and aids in control of larval fleas for 1 month.</p> <p>Treat the entire area where these pests could be present. Fleas and ticks may be re-introduced from surrounding areas by host animals.</p>
<b>House flies and Cluster flies</b>	<p>Apply low-volume mist or spray to outside surfaces of buildings, porches, patios, garages, fences, and other areas where house flies rest.</p> <p><b>Cluster flies:</b> Treat in late summer or fall, just before cluster flies begin looking for winter shelter. Spray siding, eaves, around windows and doors, window screens, and attics. To help reduce infestations, treat cracks and crevices, attics, and other indoor winter hiding places.</p>
<b>Mosquitoes</b> (Mosquitoes that may transmit Zika, Dengue, Chikungunya, and West Nile virus)	<p>Treat with spray or mist around landscape plants, turf, and ground cover, under decks, around building foundations, and other places where mosquitoes may rest.</p>
<b>Scorpions</b>	<p>Apply as a perimeter treatment to exterior walls and adjacent soil, to known or suspected harborages of scorpions. Apply spot treatments into cracks, crevices, weep holes, or other access points into hollow block walls or masonry veneer. When possible, remove piles of debris and building materials near the exterior wall that can harbor the pests. You may treat around piles of firewood, but <b>DO NOT</b> treat firewood with this product.</p>

\*Not Registered for Use in California

WOOD-INFESTING PESTS			
Drywood termites	Beetles (con't)	Beetles (con't)	Carpenter ants
Beetles	<ul style="list-style-type: none"> <li>Bark beetles</li> </ul>	<ul style="list-style-type: none"> <li>Old house borers</li> </ul>	Carpenter bees
<ul style="list-style-type: none"> <li>Ambrosia beetles</li> <li>Anobiid or deathwatch</li> </ul>	<ul style="list-style-type: none"> <li>False powderpost</li> <li>Lyctid or powder post</li> </ul>	<ul style="list-style-type: none"> <li>Wharf borers</li> </ul>	
<b>Where To Apply</b>	<ul style="list-style-type: none"> <li>For treatment of wood infested with, or subject to infestation by, wood-infesting pests.</li> <li>Apply where pests have been seen, found, or can find shelter.</li> </ul>		
<b>Use Rate</b>	<ul style="list-style-type: none"> <li>0.075% - - 0.27 fl oz (8 milliliters) (0.004 lb. imidacloprid and 0.002 lb. beta-cyfluthrin) of <b>Turonyx Ultra FX</b> per gal of water.</li> </ul>		
<b>How To Apply</b> (also see Application section)	<ul style="list-style-type: none"> <li>Apply spray or foam as described in application section.</li> <li>Treatment dilutions may also be applied to wood surfaces by paint brush or rollers.</li> <li><b>DO NOT</b> contact treated surfaces until dry.</li> </ul>		

(continued)



WOOD-INFESTING PESTS (cont.)	
When To Apply	<ul style="list-style-type: none"> <li>When pests are seen or found.</li> <li>Re-apply every 7 to 10 days if needed.</li> </ul>
Foam Applications	<ul style="list-style-type: none"> <li>Mix end-use dilution with manufacturer's specified volume of foaming agent.</li> </ul>

#### APPLICATION INSTRUCTIONS FOR WOOD-INFESTING PESTS

Drywood termites & wood-infesting beetles	<p><b>Galleries and structure voids:</b> Treat by applying sprays, mists, or foams. Locate galleries by using visual signs like frass or pellets, blistered wood, emergence or cleanout holes, the presence of live insects, mechanical sounding techniques, or listening devices (e.g., stethoscopes, acoustic emission detectors).</p> <p>Penetrate the gallery system by drilling holes to receive the injector tip or treatment tool. Distribute drill holes to adequately cover the gallery system. Apply as a low pressure spray (<b>DO NOT</b> exceed 50 psi at nozzle tip) or by misting, or where appropriate, by foaming. It is not necessary to treat to the point where runoff is detected from adjacent holes.</p> <p>Avoid drilling where electrical wiring, plumbing lines, etc. are located.</p> <p><b>DO NOT</b> apply where electrical shock hazards exist.</p> <p>Drill holes in commonly occupied areas must be sealed after treatment.</p> <p><b>Wood surfaces:</b> Treat by spray, mist, or where appropriate, foam applications. For inaccessible surfaces, drill and treat the interior of structural voids. Surfaces treated may include exposed wooden surfaces in crawlspaces, basements, or attics; wooden exterior surfaces* such as decks, fencing, or siding; structural voids; channels in damaged wood; in spaces between wooden members of a structure*; and junctions between wood and foundations*. Apply by brushing or as a coarse, low pressure spray (<b>DO NOT</b> exceed 50 psi at nozzle tip) to the wood surface; apply sufficient volume to cover the surface to the point of wetness, but avoid applying to the point of runoff.</p> <p>When spraying wood surfaces overhead in living areas, cover surfaces below the treated area with plastic sheeting or similar material. <b>DO NOT</b> contact treated surfaces until spray deposits have dried.</p>
Carpenter ants*	<p><b>Homes and other structures:</b> Apply around doors and windows and other places where carpenter ants may enter. Spray or foam into cracks and crevices, or spray, mist, or foam through small drilled holes into voids where ants or nests are present. Use enough spray or foam to cover the area. Inside trees, utility poles, fencing and decking materials and similar structural members, drill to find the interior infested cavity and inject spray, mist, or foam using a treatment tool with a splashback guard.</p> <p><b>Tunneling in soil:</b> Apply as a soil drench or inject the dilution or foam into the soil at intervals of 8 to 12 inches. Use 1 gallon of dilution per 8 sq ft. Treat along the edge of walls, driveways, or other hard surfaces where ants are tunneling beneath the surface.</p> <p><b>Protecting firewood from carpenter ants:</b> Treat soil beneath firewood before stacking at 1 gallon of dilution per 8 sq ft.</p> <p><b>DO NOT</b> treat firewood with this product.</p> <p>It is recommended to remove or prune away any shrubbery, bushes, and tree branches touching the structure. Vegetation touching the structure may offer a route of entry for ants into the structure. This may allow ants to inhabit the structure without coming in contact with the treatment.</p>
Carpenter bees	<p><b>In or on structures:</b> Apply as a spray or mist, or sufficient volume of foam, directly into gallery entrance holes. Leave entrance open to be sure that returning adult bees are killed.</p> <p>Treat exterior wood surfaces* by general surface application to prevent nest cavity excavation by adult carpenter bees.</p>

\*Not Registered for Use in California

#### APPENDIX

Use Turonyx Ultra FX as a general surface (outdoors only)\*, spot, mist, or crack and crevice treatment. Permitted areas of use are the following buildings, structures, and modes of transport:

<ul style="list-style-type: none"> <li>apartment buildings</li> <li>bakeries</li> <li>bottling facilities</li> <li>breweries</li> <li>buses</li> <li>cafeterias</li> <li>candy plants</li> <li>cereal processing and manufacturing</li> <li>plants</li> <li>correctional facilities</li> <li>dairies and dairy product processing plants</li> <li>frozen food plants</li> <li>grain mills</li> </ul>	<ul style="list-style-type: none"> <li>granaries</li> <li>greenhouses (structures only)</li> <li>hospitals</li> <li>hotels</li> <li>houses</li> <li>industrial buildings</li> <li>kitchens</li> <li>laboratories</li> <li>livestock housing</li> <li>pet kennels</li> <li>manufacturing establishments</li> <li>mausoleums</li> </ul>	<ul style="list-style-type: none"> <li>meat and produce canneries</li> <li>nursing homes</li> <li>pickle factories</li> <li>poultry houses</li> <li>processing and packing plants</li> <li>restaurants</li> <li>schools</li> <li>spice plants</li> <li>stores</li> <li>warehouses</li> <li>wineries</li> <li>transportation vessels (buses, trucks, trailers, rail cars, and marine vessels)</li> </ul>
--	---	---

\*Not Registered for Use in California





## STORAGE AND DISPOSAL

**DO NOT** contaminate water, food or feed by storage or disposal.

**PESTICIDE STORAGE:** Store in a tightly closed container in a cool, dry place. Store in original container and out of reach of children, preferably in a locked storage area.

**PESTICIDE DISPOSAL:** Pesticide spray mixture or rinsate that cannot be used should be disposed of in a landfill approved for pesticides. Improper disposal of excess pesticide spray mixture or rinsate is a violation of Federal law. **DO NOT** pour or dispose down-the-drain or sewer. Call your local solid waste agency for local disposal options. If these wastes cannot be disposed of by the use according to label instructions, contact your State Pesticide or Environmental Control Agency or the Hazardous Waste representative at the nearest EPA Regional Office for guidance.

### CONTAINER HANDLING:

**For plastic containers ≤ 5 gallons: Nonrefillable Container: DO NOT** reuse or refill this container. Triple rinse container (or equivalent) promptly after emptying. Triple Rinse as follows: Empty the remaining contents into application equipment or a mix tank and drain for 10 seconds after the flow begins to drip. Fill the container ¼ full with water and recap. Shake for 10 seconds. Pour rinsate into application equipment or a mix tank or store rinsate for later use or disposal. Drain for 10 seconds after the flow begins to drip. Repeat this procedure two more times. Then offer for recycling if available or puncture and dispose of in a sanitary landfill, or by other procedures allowed by state and local authorities.

**For plastic containers > 5 gallons: Nonrefillable container: DO NOT** reuse or refill this container. Triple rinse container (or equivalent) promptly after emptying. Triple Rinse as follows: Empty the remaining contents into application equipment or a mix tank. Fill the container ¼ full with water. Recap and tighten closures. Tip container on its side and roll it back and forth, ensuring at least one complete revolution, for 30 seconds. Stand the container on its end and tip it back and forth several times. Turn the container over onto its other end and tip it back and forth several times. Empty the rinsate into application equipment or a mix tank or store rinsate for later use or disposal. Repeat this procedure two more times. Then offer for recycling if available or puncture and dispose of in a sanitary landfill, or by other procedures allowed by state and local authorities.

## LIMITATION OF WARRANTY AND LIABILITY

**IMPORTANT: READ BEFORE USE.** Read the entire Directions for Use, Conditions of Warranties and Limitations of Liability before using this product. If these terms and conditions are not acceptable, return the unopened product container at once. By using this product, user or buyer accepts the following Disclaimer of Warranties and Limitations of Liability. **CONDITIONS:** The directions for use of this product are believed to be adequate and must be followed carefully. However, it is impossible to eliminate all risks associated with the use of this product. Ineffectiveness, injury, and other unintended consequences may result because of such factors as manner of use or application (including misuse), the presence of other materials, weather conditions, and other unknown factors, all of which are beyond the control of ATTICUS, LLC. To the extent consistent with applicable law, all such risks shall be assumed by the user or buyer.

**DISCLAIMER OF WARRANTIES:** To the extent consistent with applicable law, ATTICUS, LLC makes no other warranties, express or implied, of merchantability or of fitness for a particular purpose or otherwise, that extend beyond statements on this label. **LIMITATIONS OF LIABILITY:** To the extent consistent with applicable law, neither ATTICUS, LLC the manufacturer, nor the Seller shall be liable for any indirect, special, incidental or consequential damages resulting from the use, handling, application, storage, or disposal of this product. To the extent consistent with applicable law, the exclusive remedy of the user or buyer for any and all losses, injuries or damages resulting from the use, handling, application, or storage of this product, whether in contract, warranty, tort, negligence, strict liability or otherwise, shall not exceed the purchase price paid.

Turonyx™ is a trademark of Atticus, LLC

Temprid® is a registered trademark of Bayer.

20240223ap1



INDOXACARB	GROUP	22A	INSECTICIDE
------------	-------	-----	-------------



## Insecticide

**FOR USE IN RESIDENTIAL, INSTITUTIONAL, COMMERCIAL, AND INDUSTRIAL AREAS**

**Active Ingredient:**

Indoxacarb\*  
(S)-methyl 7-chloro-2,5-dihydro-2-[[[(methoxycarbonyl)  
[4(trifluoromethoxy) phenyl]amino] carbonyl]indeno[1,2-e]  
[1,3,4]oxadiazine-4a-(3H)carboxylate . . . . . 0.05%

Other Ingredients	99.95%
-------------------	--------

<b>Total:</b>	<b>100.00%</b>
---------------	----------------

\*Indoxacarb belongs to the oxadiazine chemical class.

## KEEP OUT OF REACH OF CHILDREN

Si usted no entiende la etiqueta, busque a alguien para que se la explique a usted en detalle. (If you do not understand the label, find someone to explain it to you in detail.)

**DO NOT TREAT AREAS THAT ARE EASILY ACCESSIBLE TO CHILDREN AND PETS.**

EPA Reg. No. 100-1715

EPA Est. 92418-ESP-1

**SCP 1715A-L1 1022**

**3 x 0.14 oz (4 g)**

**Net Contents**



### FIRST AID

Have the product container or label with you when calling a poison control center or doctor or going for treatment.

### HOTLINE NUMBER

For 24-Hour Medical Emergency Assistance (Human or Animal)  
Or Chemical Emergency Assistance (Spill, Leak, Fire or Accident)  
Call  
**1-800-888-8372**

## PRECAUTIONARY STATEMENTS

### HAZARDS TO HUMANS AND DOMESTIC ANIMALS

Avoid contact with skin, eyes or clothing. Prolonged or frequently repeated skin contact may cause allergic reactions in some individuals. User should wash hands thoroughly with soap and water after handling and before eating, drinking, chewing gum, using tobacco, or using the toilet.

### ENVIRONMENTAL HAZARDS

This pesticide is toxic to fish and aquatic invertebrates. Do not apply directly to water, or to areas where surface water is present, or to intertidal areas below the mean high water mark. Do not contaminate water when disposing of equipment washwater or rinsate. Runoff may be hazardous to aquatic organisms in water adjacent to treated areas. Runoff of this product will be reduced by avoiding applications when rainfall is forecasted to occur within 24 hours. Rinsing application equipment over the treated area will help avoid runoff to water bodies or drainage systems. Do not apply to any impervious surfaces which may contact or lead directly to surface water, storm drains, or urban runoff conveyance systems (gutters).

### Physical and Chemical Hazards

Do not use this product in or on electrical equipment where a possibility of shock hazard exists.

## DIRECTIONS FOR USE

It is a violation of federal law to use this product in a manner inconsistent with its labeling.

### PRODUCT INFORMATION

Advion® Ant Gel Station is a ready-to-use bait station that is pre-filled with a gel bait to control major ant pest species, including Acrobat, Argentine, Big-headed, Carpenter, Cornfield, Crazy, Field, Ghost, Honey, Little black, Odorous house, Pavement, Pyramid, Rover, Thief, and White-footed ants. Use of Advion Ant Gel Stations will kill ants within 6 days of placement if used according to the directions.

Advion Ant Gel Station is effective at killing Pharaoh ants, foraging red imported fire ants, and harvester ants. For complete control of outdoor nests of these species, use additional treatments labeled for outdoor nest control.

### INSECT RESISTANCE MANAGEMENT

INDOXACARB	GROUP	22A	INSECTICIDE
------------	-------	-----	-------------

For resistance management, Advion Ant Gel Station contains a Group 22A insecticide. Any insect population may contain individuals naturally resistant to Advion Ant Gel Station and other Group 22A insecticides. The resistant individuals may dominate the insect population if this group of insecticides are used repeatedly in the same treated areas. Appropriate resistance-management strategies should be followed.

To delay insecticide resistance, take the following steps:

- Rotate the use of Advion Ant Gel Station or other Group 22A insecticides with different groups that control the same pests.
- Adopt an integrated pest management program for insecticide use that includes scouting, uses historical information related to pesticide use, record keeping, and which considers cultural, biological, and other chemical control practices.
- Monitor after application for unexpected target pest survival. If the level of survival suggests the presence of resistance, consult with your local university specialist or certified pest control advisor.

*continued...*

Contact your local Syngenta representative, retailer, or extension specialist for any additional pesticide resistance-management and/or IPM recommendations for the specific site and pest problems in your area. For further information or to report suspected resistance, contact Syngenta at 1-866-SYNGENT(A) (866-796-4368).

Syngenta encourages responsible product stewardship to ensure effective long-term control of the insects on this label.

### **Use Restrictions**

- **DO NOT** place bait stations in areas that are easily accessible to children, pets, and zoo animals.
- **DO NOT** place bait stations near food preparation surfaces.
- **DO NOT** spray other insecticides over the top of the station as this may cause the bait inside to become unattractive.
- **DO NOT** place bait stations near areas or on surfaces where the temperature exceeds 120-130°F as bait may liquefy. Examples include, but are not limited to, portions of stoves, ovens, grills, fume hoods, heat lamps, coffee urns, steam tables, toasters, fryers, dishwashers, and hot water pipes.
- **DO NOT** place Advion Ant Gel Station in areas where food/feed, food utensils or food processing surfaces may come into contact and become contaminated.
- **DO NOT** place Advion Ant Gel Station in areas that are routinely washed such as cracks and crevices in the tops of tables, tops of food/feed preparation surfaces, and holding surfaces for prepared foods.

### **Use Precautions**

- Activate the station as directed but avoid direct contact with the gel.
- When placed outdoors, ensure bait stations are placed in areas that are not exposed to direct rainfall.
- Avoid spraying over or around the Advion Ant Gel Station with other insecticides as this may interfere with ants entering the station and reduce the product's effectiveness.

## **DIRECTIONS FOR USE FOR PROFESSIONALS**

### **Application Directions**

Advion Ant Gel Stations can be used indoors or outdoors in single and multi-family residential homes, institutional, commercial, and industrial facilities, including schools, warehouses, apartments, supermarkets, restaurants, motels, hotels, hospitals, nursing homes, offices, zoos, retail establishments, food handling/storage establishments, and transportation equipment, such as aircraft, trains, ships, boats, and buses, and other similar sites where ant infestations occur.

### **Use Directions**

- Inspect infested areas carefully to determine overall infestation levels and identify areas where ants are trailing or nesting to determine the most appropriate locations for the stations.
- **Indoors:** Place bait stations in areas including, but not limited to, pest entry sites, attics, wall voids, behind cabinets or equipment, under counters or appliances, along baseboards and adjacent to plumbing penetrations. Placement sites can include areas along walls or floors, behind or under equipment or appliances, under tables or furniture, around sinks, in cabinets, within or near garbage collection areas, and attics and crawl spaces.
- **Outdoors** (such as patios, decks, around landscaping): Place bait stations where ants are likely to enter the structure, such as utility penetrations or gaps around doors, windows, soffits, between construction elements, sewer areas, adjacent trees which harbor ants, along walls, garbage holding areas, or other placement sites acting as an ant harborage. Efforts to limit access of ants into the structure such as sealing cracks around doors, windows, or utility penetrations can be helpful in reducing ant infestations.
- Inspect Advion Ant Gel Station placements periodically and replace with new stations as needed.

### **Activation and Placement of Bait Stations**

Prepare stations as directed before placing in areas of ant activity.

To use the station (see drawing below), follow these steps:

1. Remove bait station from packaging.
2. Cut or snap off the tab at the end of the bait station.
3. Activate the bait station by squeezing the gel compartment so the gel inside is moved into the central compartment of the station.
4. Place bait station near ant trails or other areas where ant activity has been observed.

When placing Advion Ant Gel Stations in active ant foraging areas, avoid disrupting the natural foraging behavior of ants.

### **Number of Bait Stations to Use and Retreatment Intervals**

#### **Indoors**

Place 3-8 Advion Ant Gel Stations in an average sized room (10' x 10').

- When ant activity is low, fewer stations can be used (1-4 stations per room).
- When ant activity is high, or the room size is bigger, more stations should be used.

#### **Outdoors**

Bait stations should be placed adjacent to the home or structure near ant activity or anywhere ants may gain access to the home or structure such as around doors and windows, utility penetrations, and other areas where ants are likely to enter.

### **Applications in Non-food/Non-feed Handling Areas**

Advion Ant Gel Station is designed to control ants in residential structures and the non-food/non-feed areas of commercial, industrial, public and institutional buildings/structures, including restaurants, warehouses, food processing plants, supermarkets, hospitals, nursing homes, motels, hotels, schools, laboratories, computer facilities, aircraft, buses, boats/ships, trains, pet shops, and zoos.

Non-food/non-feed areas include areas, such as garbage rooms, lavatories, floor drains (to sewers), entries and vestibules, offices, locker rooms, machine rooms, boiler rooms, garages, mop closets, and storage (after bottling or canning). Refer to the section below for use directions and restrictions when making applications in food/feed handling areas of Food/Feed Handling Establishments.

### **Applications in Food/Feed Handling Areas**

Food and feed handling areas include areas for receiving, storage, packing (canning, bottling, wrapping, boxing), preparing, edible waste storage, and enclosed processing systems (mills, dairies, edible oils, syrups). Serving areas are also considered a food/feed area when food is uncovered and the facility is in operation.

- Do not place Advion Ant Gel Station in areas where food/feed, food utensils or food processing surfaces may come into contact and become contaminated.
- Do not place Advion Ant Gel Station in areas that are routinely washed such as cracks and crevices in the tops of tables, tops of food/feed preparation surfaces, and holding surfaces for prepared foods.
- Do not place Advion Ant Gel Station near or on surfaces where the temperature exceeds 120-130°F because this could cause the bait to liquefy and lose effectiveness.
  - o Examples include, but are not limited to, parts of stoves, ovens, grills, fume hoods, saunas, heat lamps, coffee urns, steam tables, toasters, fryers, dishwashers, and hot water pipes.

## DIRECTIONS FOR USE FOR CONSUMERS

### APPLICATION DIRECTIONS

Advion Ant Gel Stations can be used indoors or outdoors in single and multi-family residential homes, including schools, daycare centers, apartments, motels, hotels, and recreational equipment, such as boats and RV's, and other similar sites where ant infestations occur.

### Activation and Placement of Bait Stations

Prepare stations as directed before placing in areas of ant activity.

To use the station (see drawing below), follow these steps:

1. Remove bait station from packaging.
2. Cut or snap off the tab at the end of the bait station.
3. Activate the bait station by squeezing the gel compartment so the gel inside is moved into the central compartment of the station.
4. Place the bait station near ant trails or other areas where ant activity has been observed.

When placing Advion Ant Gel Stations in active ant foraging areas, avoid disrupting the natural foraging behavior of ants.

### Number of Bait Stations to Use and Retreatment Intervals

#### Indoors

Place 3-8 Advion Ant Gel Stations in an average sized room (10' x 10').

- When ant activity is low, fewer stations can be used (1-4 stations per room).
- When ant activity is high or the room size is bigger, more stations should be used.

#### Outdoors

Bait stations should be placed adjacent to the home or structure near ant activity or anywhere ants may gain access to the home or structure such as around doors and windows, utility penetrations, and other areas where ants are likely to enter.

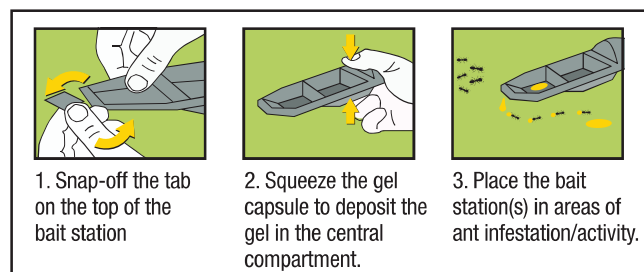

## STORAGE AND DISPOSAL

Do not contaminate water, food or feed by storage and disposal.

### Pesticide Storage

Store in cool, dry place inaccessible to children and pets.

### Pesticide Disposal

Wastes resulting from the use of this product must be disposed of on site or at an approved waste disposal facility.

### Container Handling

**Nonrefillable Container:** Do not reuse or refill this container. Offer for recycling if available. Place empty bait dispensers in trash. If partially filled, wrap in newspaper and discard in trash or call your local solid waste authority for disposal instructions.

## CONDITIONS OF SALE AND LIMITATION OF WARRANTY AND LIABILITY

**NOTICE:** Read the entire Directions for Use and Conditions of Sale and Limitation of Warranty and Liability before buying or using this product. If the terms are not acceptable, return the product at once, unopened, and the purchase price will be refunded.

The Directions for Use of this product must be followed carefully. It is impossible to eliminate all risks inherently associated with the use of this product. Crop injury, ineffectiveness or other unintended consequences may result because of such factors as manner of use or application, weather or crop conditions, presence of other materials or other influencing factors in the use of the product, which are beyond the control of SYNGENTA CROP PROTECTION, LLC or Seller. To the extent permitted by applicable law, Buyer and User agree to hold SYNGENTA and Seller harmless for any claims relating to such factors.

SYNGENTA warrants that this product conforms to the chemical description on the label and is reasonably fit for the purposes stated in the Directions for Use, when used in accordance with directions under normal use conditions. To the extent permitted by applicable law: (1) this warranty does not extend to the use of this product contrary to label instructions or under conditions not reasonably foreseeable to or beyond the control of Seller or SYNGENTA, and (2) Buyer and User assume the risk of any such use. **TO THE EXTENT PERMITTED BY APPLICABLE LAW, SYNGENTA MAKES NO WARRANTIES OF MERCHANTABILITY OR OF FITNESS FOR A PARTICULAR PURPOSE NOR ANY OTHER EXPRESS OR IMPLIED WARRANTY EXCEPT AS WARRANTED BY THIS LABEL.**

To the extent permitted by applicable law, in no event shall SYNGENTA be liable for any incidental, consequential or special damages resulting from the use or handling of this product. **TO THE EXTENT PERMITTED BY APPLICABLE LAW, THE EXCLUSIVE REMEDY OF THE USER OR BUYER, AND THE EXCLUSIVE LIABILITY OF SYNGENTA AND SELLER FOR ANY AND ALL CLAIMS, LOSSES, INJURIES OR DAMAGES (INCLUDING CLAIMS BASED ON BREACH OF WARRANTY, CONTRACT, NEGLIGENCE, TORT, STRICT LIABILITY OR OTHERWISE) RESULTING FROM THE USE OR HANDLING OF THIS PRODUCT, SHALL BE THE RETURN OF THE PURCHASE PRICE OF THE PRODUCT OR, AT THE ELECTION OF SYNGENTA OR SELLER, THE REPLACEMENT OF THE PRODUCT.**

SYNGENTA and Seller offer this product, and Buyer and User accept it, subject to the foregoing Conditions of Sale and Limitation of Warranty and of Liability, which may not be modified except by written agreement signed by a duly authorized representative of SYNGENTA.

Advion®, the ALLIANCE FRAME, the SYNGENTA Logo and the PURPOSE ICON are Trademarks of a Syngenta Group Company

©2023 Syngenta

For non-emergency (e.g., current product information), call Syngenta Crop Protection at 1-800-334-9481

Manufactured for:  
Syngenta Crop Protection, LLC  
P.O. Box 18300  
Greensboro, North Carolina 27419-8300



**Maxforce<sup>®</sup>**  
**COMPLETE**

BRAND

## GRANULAR INSECT BAIT

FOR INDOOR AND OUTDOOR CONTROL OF ANTS, CRICKETS AND  
ROACHES'  
FOR USE IN AND AROUND STRUCTURES AND RESIDENTIAL AREAS

**ACTIVE INGREDIENTS:**

Hydramethylnon†: tetrahydro-5, 5-dimethyl-2(1H)-pyrimidinone,  
(3-(4-(trifluoromethyl) phenyl)-1-(2-(4-(trifluoromethyl) phenyl)  
ethenyl)-2-propenylidene) hydrazine..... 1.00%

**OTHER INGREDIENTS:**..... 99.00%

**TOTAL:**..... 100.00%

†CAS No. 67485-29-4

EPA Reg. No. 432-1255

EPA Est. No. 67572-GA-1

### KEEP OUT OF REACH OF CHILDREN CAUTION

**PRECAUTION: AL USUARIO:**  
Si usted no lee ingles no use  
este producto hasta que la  
etiqueta le haya sido  
explicada ampliamente.

See Back Panel for First Aid  
Instructions and Booklet for  
Complete Precautionary Statements  
and Directions for Use.

Net Weight

**8 Ounces (227 g)**

**79898851**

80021658E 200122AV1

Ants, Crickets And Roaches





FIRST AID	
If on skin or clothing:	<ul style="list-style-type: none"> <li>• Take off contaminated clothing.</li> <li>• Rinse skin immediately with plenty of water for 15-20 minutes.</li> <li>• Call a poison control center or doctor for treatment advice.</li> </ul>
Have the product container or label with you when calling a poison control center or doctor or going for treatment. You may also contact 1-800-334-7577 for emergency treatment information.	

QUESTIONS? COMMENTS? Call: 1-800-331-2867.

This Maxforce Complete Brand Granular Insect Bait controls:

Roaches <sup>1</sup>	Crickets	Silverfish	Firebrats	Earwigs
----------------------	----------	------------	-----------	---------

Ants including the following ant species:

Acrobat	Carpenter	Field	Harvester	Pharaoh
Argentine	Cornfield	Fire <sup>2</sup>	Odorous House	Thief
Big Headed	Crazy	Ghost	Pavement	

<sup>1</sup> German, American, Oriental, and Smoky Brown Roaches

<sup>2</sup> Native and Imported

**PRECAUTIONARY STATEMENTS**  
**HAZARDS TO HUMANS AND DOMESTIC ANIMALS**  
**CAUTION**

Harmful if absorbed through skin. Avoid contact with eyes, skin, or clothing. Prolonged or frequently repeated skin contact may cause allergic reaction in some individuals.

**Personal Protective Equipment (PPE)**

Applicators and handlers must wear: Shoes plus socks.  
Follow manufacturer's instruction for cleaning/maintaining PPE. If no such instructions for washables exist, use detergent and hot water. Keep and wash PPE separately from other laundry.

USER SAFETY RECOMMENDATIONS
User should wash hands before eating, drinking, chewing gum, using tobacco, or using the toilet.
Users should remove clothing/PPE immediately if pesticide gets inside. Then wash thoroughly and put on clean clothing.
Users should remove PPE immediately after handling this product. As soon as possible, wash thoroughly and change into clean clothing.

**ENVIRONMENTAL HAZARDS**

This product is toxic to fish. Do not apply directly to water, or to areas where surface water is present or to intertidal areas below the mean high water mark. Do not contaminate water when cleaning equipment or disposing of equipment washwaters.

**PRODUCT INFORMATION**

MAXFORCE® COMPLETE BRAND GRANULAR INSECT BAIT is a ready-to-use product for use indoors

and outdoors and around buildings, on lawns, and other non-crop areas\* such as residential areas, the non-food/non-feed areas of institutional and commercial establishments including warehouses, restaurants, food processing plants, supermarkets, hospitals, nursing homes, motels, hotels, apartment buildings, schools, laboratories, computer facilities, pet shops, zoos, sewers, highway rights-of-way and medians, traffic islands, utility rights-of-way (including power lines, pipelines, aqueducts) managed turf areas (non-crop) (including school yards, playgrounds, athletic fields, amusement parks, picnic areas, recreation areas, office parks, industrial grounds, airports, shopping centers, public parks, arboretums, public gardens, monument sites, cemeteries and mausoleums, golf courses, race tracks, fairgrounds, outdoor amphitheatres, sod farms, and ornamental nurseries). Do not graze or feed lawn or sod clippings to livestock. MAXFORCE COMPLETE BRAND GRANULAR INSECT BAIT contains a special blend of foods, combined with the delayed-action stomach poison, hydramethylnon. The delayed action of the active ingredient allows foraging ants to bring the bait back to the nest so that the entire colony, including the queen, is destroyed. When properly used, this bait will control many of the following insects, including ants, cockroaches<sup>1</sup>, crickets, and silverfish before they can enter a structure. Expect to see fewer insects within a week.

\*Do not use on other non-crop areas in California.

MAXFORCE COMPLETE BRAND GRANULAR INSECT BAIT bulk container may be used on the job site or to fill this product's refillable service containers. The bulk container will refill approximately 8 refillable service containers. Reuse only those service containers with current and legible labels.

**APPLICATION RESTRICTIONS**

Do not apply this product by any method not specified on this label. The use of this product on pasture and rangeland is unlawful. Do not graze or feed lawn or sod clippings to livestock. DO NOT USE ON EDIBLE FOOD CROPS OR ON AREAS INTENDED FOR EDIBLE FOOD CROP PRODUCTION. Not for use in USDA meat and poultry plants. Do not apply other insecticides (such as aerosols, sprays, etc.) on top or in close proximity to this product, as it will reduce effectiveness.

**DIRECTIONS FOR USE**

**It is a violation of Federal law to use this product in a manner inconsistent with its labeling.**

**APPLICATION INSTRUCTIONS**

**KEEP PEOPLE AND PETS OUT OF AREA DURING APPLICATION.**

**FOR OUTDOOR USE**

**1. AROUND STRUCTURES:** MAXFORCE COMPLETE BRAND GRANULAR INSECT BAIT may be sprinkled around structures and/or applied to refillable/serviceable bait stations as outlined below. Sprinkle this product evenly in a 1 - 2 foot wide band adjacent to the structure at a rate of 0.5 oz (one tablespoon) of bait per 25 linear feet. NOTE: Around structures the total application should not exceed 4 - 8 oz per 200-400 linear feet (or 0.5 oz per 25 linear feet). A typical application would be 4 - 8 oz adjacent to an average sized home of 200-400 linear feet. Be sure to treat areas such as porches, patios, driveways, sidewalks, flower gardens, landscape timbers and around trees, wood piles, air conditioning units and garbage receptacles. DO NOT USE ON EDIBLE FOOD CROPS OR ON AREAS INTENDED FOR EDIBLE FOOD CROP PRODUCTION. Treat visible ant trails as well as cracks or crevices where insects (ants, roaches, crickets) may enter a structure.

**REFILLABLE STATIONS:** MAXFORCE COMPLETE BRAND GRANULAR INSECT BAIT may be placed into refillable tamper resistant bait stations. Place up to 1 to 3 oz (2 to 6 Tbsp.) of bait into tamper resistant stations and close securely after application. During follow-up visits inspect placements

and reapply as needed. Refillable tamper resistant stations should be placed every 20 - 30 feet around the perimeter of a structure. Use approximately 2 stations per side of a typical single family home. For best results, place stations near: air conditioning units, water faucets, foundation vents and weep holes, decks, utility entryways (e.g. electrical, cable TV) and wherever target pests are frequently found. Stations may also be placed along fence lines and property lines to intercept foraging pests. Regularly inspect all stations and replace bait as needed for continual control. Position Refillable Bait Stations in areas where they will not be damaged by lawn equipment such as mowers and trimmers. If the station is not equipped with a sticker to identify the contents, apply a sticker to the outside or inside of the station.

**2. BROADCAST APPLICATION:** Broadcast this product uniformly at a rate of 1 oz per 1,800 sq ft (equivalent to 1.5 lbs/A).

**3. FIRE ANTS<sup>1</sup> AND OTHER MOUND BUILDING ANTS<sup>2</sup>:** Sprinkle approximately two tablespoons (1 oz) of bait around each mound. For best results, do not apply bait directly in or on the mound. Do not disturb the mound. Ants that are agitated may not feed on the bait.

**FOR INDOOR USE**

**AVOID CONTAMINATION OF FOOD, FOOD CONTACT SURFACES AND FEEDSTUFFS.** NOTE: Indoor applications are limited to areas that are inaccessible to children or pets, such as cracks, crevices, wall voids, unfinished attics, crawl spaces, refillable tamper-resistant bait stations, and behind electrical switch plates, within residential and non-residential buildings or structures and within non-food/non-feed areas of industrial, institutional, and commercial buildings. Non-food/non-feed areas include bedrooms, living rooms, bathrooms, closets, media rooms, garbage rooms, lavatories, entries, vestibules, offices, locker rooms, machine rooms, boiler rooms, garages, mop closets, and storage (after canning or bottling).

Apply up to 0.5 oz (one tablespoon) of bait per crack, crevice or other inaccessible areas where insects may hide or live. Apply product using suitable application equipment (such as the Centro Bait Master.) Wipe up any loose or excess granules. Apply evenly in unfinished attics and crawl spaces at a rate of 0.5 oz per 100 sq ft only if the space is secured or otherwise inaccessible to children and domestic animals.

<sup>1</sup> German, American, Oriental, and Smoky Brown Roaches

<sup>2</sup> Native and Imported

<sup>3</sup> Pavement, Field, Cornfield, and Harvester Ants

**STORAGE AND DISPOSAL**

Do not contaminate water, food, or feed by storage or disposal.

**PESTICIDE STORAGE:** Store in original container in a cool dry secure area (out of reach of children).

Keep container closed when not in use. Avoid contamination with other insecticides.

**PESTICIDE DISPOSAL:** Wastes resulting from the use of this product may be disposed of on-site or at an approved waste disposal facility.

**CONTAINER HANDLING: Refillable service container**

Refillable container. Refill this container with MAXFORCE COMPLETE BRAND GRANULAR INSECT BAIT only. Do not reuse this container for any other purpose. If empty: Place in trash or offer for recycling if available. If partly filled: Call your local solid waste agency for disposal instructions. Never place unused product down any indoor or outdoor drain.

## IMPORTANT: READ BEFORE USE

Read the entire Directions for Use, Conditions, Disclaimer of Warranties and Limitations of Liability before using this product. If terms are not acceptable, return the unopened product container at once. By using this product, user or buyer accepts the following Conditions, Disclaimer of Warranties and Limitations of Liability.

**CONDITIONS:** The directions for use of this product are believed to be adequate and must be followed carefully. However, it is impossible to eliminate all risks associated with the use of this product. Crop injury, ineffectiveness or other unintended consequences may result because of such factors as weather conditions, presence of other materials, or the manner of use or application, all of which are beyond the control of Bayer CropScience LP. All such risks shall be assumed by the user or buyer.

**DISCLAIMER OF WARRANTIES:** TO THE EXTENT CONSISTENT WITH APPLICABLE LAW, BAYER CROPSCIENCE LP MAKES NO OTHER WARRANTIES, EXPRESS OR IMPLIED, OF MERCHANTABILITY OR OF FITNESS FOR A PARTICULAR PURPOSE OR OTHERWISE, THAT EXTEND BEYOND THE STATEMENTS MADE ON THIS LABEL. No agent of Bayer CropScience LP is authorized to make any warranties beyond those contained herein or to modify the warranties contained herein. TO THE EXTENT CONSISTENT WITH APPLICABLE LAW, BAYER CROPSCIENCE LP DISCLAIMS ANY LIABILITY WHATSOEVER FOR SPECIAL, INCIDENTAL OR CONSEQUENTIAL DAMAGES RESULTING FROM THE USE OR HANDLING OF THIS PRODUCT.

**LIMITATIONS OF LIABILITY:** TO THE EXTENT CONSISTENT WITH APPLICABLE LAW, THE EXCLUSIVE REMEDY OF THE USER OR BUYER FOR ANY AND ALL LOSSES, INJURIES OR DAMAGES RESULTING FROM THE USE OR HANDLING OF THIS PRODUCT, WHETHER IN CONTRACT, WARRANTY, TORT, NEGLIGENCE, STRICT LIABILITY OR OTHERWISE, SHALL NOT EXCEED THE PURCHASE PRICE PAID, OR AT BAYER CROPSCIENCE LP'S ELECTION, THE REPLACEMENT OF PRODUCT.

Bayer (reg'd), the Bayer Cross (reg'd) and Maxforce® are registered trademarks of Bayer.

Produced for:  
Bayer Environmental Science  
A Division of Bayer CropScience LP  
5000 CentreGreen Way, Suite 400  
Cary, NC 27513

**Bayer**

FIRST AID

If on skin or clothing:

- Take off contaminated clothing.
- Rinse skin immediately with plenty of water for 15-20 minutes.
- Call a poison control center or doctor for treatment advice.

Have the product container or label with you when calling a poison control center or doctor or going for treatment. You may also contact 1-800-334-7577 for emergency treatment information.

QUESTIONS? COMMENTS? Call: 1-800-331-2867.

PRECAUTIONARY STATEMENTS  
HAZARDS TO HUMANS AND DOMESTIC ANIMALS

CAUTION

Harmful if absorbed through skin. Avoid contact with eyes, skin, or clothing. Prolonged or frequently repeated skin contact may cause allergic reaction in some individuals.

ENVIRONMENTAL HAZARDS

This product is toxic to fish. Do not apply directly to water, or to areas where surface water is present or to intertidal areas below the mean high water mark. Do not contaminate water when cleaning equipment or disposing of equipment washwaters.

STORAGE AND DISPOSAL

Do not contaminate water, food, or feed by storage or disposal.  
**PESTICIDE STORAGE:** Store in original container in a cool dry secure area (out of reach of children).

Keep container closed when not in use. Avoid contamination with other insecticides, of on-site or at an approved waste disposal facility.

**PESTICIDE DISPOSAL:** Wastes resulting from the use of this product may be disposed of on-site or at an approved waste disposal facility.  
**CONTAINER HANDLING:** Refillable service container  
Refillable container. Refill this container with MAX-FORCE COMPLETE BRAND GRANULAR INSECT BAIT only. Do not reuse this container for any other purpose. If empty: Place in trash or offer for recycling if available. If partly filled: Call your local solid waste agency for disposal instructions. Never place unused product down any indoor or outdoor drain.



BRAND GRANULAR INSECT BAIT

FOR INDOOR AND OUTDOOR CONTROL OF ANTS, CRICKETS AND ROACHES\*

FOR USE IN AND AROUND STRUCTURES AND RESIDENTIAL AREAS

ACTIVE INGREDIENTS:

Hydramethylnon†: tetrahydro-5, 5-dimethyl-2(1H-pyrimidinone, (3-(4-(trifluoromethyl) phenyl)-1-(2-(4-(trifluoromethyl) phenyl) ethenyl)-2-propenylidene) hydrazine.....

1.00%

OTHER INGREDIENTS:

99.00%

TOTAL:

100.00%

†CAS No. 67485-29-4

EPA Reg. No. 432-1255

EPA Est. No. 67572-GA-1

KEEP OUT OF REACH OF CHILDREN  
CAUTION

PRECAUTION: AL USUARIO: Si usted no lee ingles no use este producto hasta que la etiqueta le haya sido explicada ampliamente.

See Panel for First Aid Instructions and Booklet for Complete Precautionary Statements and Directions for Use.



(01)00785740196632

Produced for:  
Bayer Environmental Science  
A Division of Bayer CropScience LP  
5000 CentreGreen Way, Suite 400  
Cary, NC 27513

Bayer

Net Weight

8 Ounces (227 g)

79898851

80021658E 200122AV1



[illegible]

**SILVERFISH:** Apply SPECIRE PS Insecticide as an injection treatment into cracks and crevices of baseboards, door frames, bookcases and other harborage sites. Also make spot treatments to areas such as storage areas; closets; around water pipes, doors and windows; around refrigerators, cabinets, sinks, stoves and other equipment; shelves and drawers. **CRAWLING**

[illegible]

**WEEVILS, INDIANMEAL MOTHS AND TROGODEMIDS** (in exposed adult and larval stages): Apply SPECIFIC PS Insecticide into cracks, crevices and/or voids where these pests may harbor such as cracks and devices in cabinets and pantries, wall voids, around window and door frames, and in machinery. Also make spot treatments to areas such as storage areas, closets, around water

**WEEVILS, INDIANMEAL MOTHS and TROGODERMAS** (in exposed adult and larval stages): Apply SPECIRE PS Insecticide into cracks, crevices and/or voids where these pests may harbor such as cracks and crevices in cabinets and pantries, wall voids, around window and door frames, and in machinery. Also make spot treatments to areas such as storage areas; closets; around water

cracks and crevices in cabinets and pantries, wall voids, around window and door frames, and in machinery. Also make spot treatments to areas such as storage areas; closets; around water

in machinery. Also make spot treatments to areas such as storage areas; closets; around water

EPA Est. No: 53883-TX-002

KEEP OUT OF REACH OF CHILDREN

REN

behind siding, wall voids, around window and door frames. **CARPENTER BEES:** Local entrance holes where insects may harbor, configure or imbedinate such as cracks and crevices. Treat galleries through entrance holes with SPECTRE PS Insecticide. Seal bee entrances holes.

**Sowbugs and Springtails:** Apply as an Injection or spot treatment into cracks and crevices where insects may enter premises or harbor such as weep holes, under siding, wall voids, attics, around attic vents, cracks, crevices and openings around windows doors and pipes.

**INSPECTRE PS** Insecticide as an injection or spot treatment to areas where flies roost, concentrate

Enter the structure on both the exterior and interior. Apply around doors, windows, garages,

**STORAGE AND DISPOSAL**

Do not contaminate water, food or feed by storage or disposal. **PESTICIDE STORAGE:** Store this product in a cool, dry (preferably locked) place away from heat or open flame, in an area that is not used for food storage and similar areas.

---

**DISPOSAL:** Do not puncture or incinerate! **If Empty:** Place in trash or offer for recycling is product may be disposed of on site or at an approved waste disposal facility. **CONTAINER** available. **If partly filled:** Call your local solid waste agency for disposal instructions.

Do not apply directly to water or to

exclusive remedy of the user or buyer for any and all losses, injuries or damages resulting from the use or handling of this product, including, but not limited to, death, personal injury, property damage, economic loss, or any other damages, including reasonable attorneys' fees and costs.

strict liability or otherwise, shall not exceed the purchase price paid or at Control Solutions, Inc. election, the replacement of product.

WITH ITS LABELING.

