

HAAN

*engineering clean.*TM

Deluxe Personal
**SANITIZING
STEAM CLEANER**

WITH COMPLETE ACCESSORY PACKAGE



HS-20



The Awesome
Power of Steam
Right at Your
Fingertips!

Clean and Sanitize
Nearly Everything
In and Around,
Your Home.

User Manual

Notice

The information contained in this document is subject to change without notice.

HAAN Corporation assumes no responsibility for any errors that may appear in this document nor does it make expressed or implied warranty of any kind with regard to this material, including, but not limited to, the implied warranties of merchantability and fitness for a particular purpose.

HAAN Corporation shall not be liable for incidental or consequential damages in connection with or arising out of the furnishing, performance, or use of this document and the program materials which it describes.

Edition 1, January 2009

Printed in Korea

Product manufactured in China

All rights reserved. No part of this document may be photocopied, reproduced or translated to another language without prior written consent of HAAN Corporation.

HAAN engineering clean™ is a trademark of HAAN Corporation.



Introduction

The easy way to clean and sanitize every nook, cranny and corner.

Congratulations on purchasing the HAAN HS-20 Deluxe Personal Sanitizing Steam Cleaner. Now you have an easy way to clean and sanitize all those hard-to-reach places.

Your handheld steamer uses the power of 212°F steam to remove tough grease, dirt and grime. Steam is nature's purest and most powerful cleaner for safely cleaning nearly every surface in your home without harsh chemicals, for a perfectly ecological approach. No film — no residue.

The HAAN HS-20 Deluxe Personal Sanitizing Steam Cleaner is so easy to use. Simply choose the best attachment for the cleaning projects you want to tackle and steam away!



Look for the HAAN 'steamlet' symbol in this manual for Helpful HAAN Hints that will help you make the most of your new HAAN Steam Cleaner.

Backed with a one-year limited warranty, your quality HAAN HS-20 Deluxe Personal Sanitizing Steam Cleaner is sure to give you years of dependability. And our Customer Care representatives are available to answer any of your questions.

Thousands of customers have already fallen in love with HAAN steam cleaners. We're confident you will, too.

Thank you again for purchasing the HAAN HS-20 Deluxe Personal Sanitizing Steam Cleaner.

The HAAN Team



Important Safety Information

IMPORTANT



Be sure to read **ALL** instructions and warnings **before** using your HAAN Steam Cleaner.



WARNING

Risk of electrical shock - be sure to read and follow all instructions and warnings.



CAUTION

The HS-20 emits steam at 212°F to sanitize the area of use. This means the unit's attachment system and all the accessories get very hot during use. Care should be taken when using this appliance and **DO NOT** touch them during use except in the approved manner. Exercise care when changing accessories and follow removal/changing instructions as outlined in this manual.

SAVE THESE INSTRUCTIONS - For household use only. Any other use of this appliance will void the manufacturer's warranty.

FOR HOUSEHOLD USE ONLY

When using your steam cleaner, basic safety precautions should always be observed, including the following:

WARNING – To reduce the risk of fire, electric shock or injury:

1. **DO NOT** leave the product unattended with the power turned on. Unplug the unit from outlet when not in use and before conducting any maintenance or troubleshooting.
2. When not in use, the product's power cord should be unplugged.
3. **DO NOT** service the steam cleaner when it is plugged in.
4. **DO NOT** use with a damaged cord or plug. **DO NOT** use the steam cleaner if it has been dropped, damaged, left outdoors or dropped into water. Return to a service center.
5. Store the product in a place that is out of the reach of small children and close attention is necessary when used near children.
6. Make sure to use the product according to this user manual, and use only authentic product parts and accessories.
7. **DO NOT** use in close proximity to flammable materials.
8. To unplug the power cord, simply grasp the plug. **DO NOT** pull on the power cord itself. Do not pull or carry by the cord, use the cord as a handle, close door on the cord, pull cord around sharp corners or expose cord to heated surfaces.
9. **DO NOT** handle the power cord with wet hands.
10. Store the product in a cool place indoors.
11. **DO NOT** immerse the unit or expose the unit to rain.
12. **DO NOT** spray steam in the direction of another person, animal or electrical outlet.
13. Make sure to unplug the power cord prior to filling the product with water.
14. **DO NOT** allow to be used as a toy.
15. Not for space heating purposes.
16. **DO NOT** use the product with water that has been combined with detergent, descaling, aromatic, alcohol, rinse and/or any other sort of chemicals. Use water only.



WARNING

DO NOT modify the plug. Improper connection of the equipment-grounding conductor can result in a risk of electrical shock.

IMPORTANT

Use regular tap water, or if the tap water in your area is hard, we recommend you use distilled/purified water. Always empty water from water tank after use.

17. To refill the product with water during use, follow the directions on pg 8. Unplug the product before attempting to add water.
18. The product and accessories become hot during use. Exercise care when changing accessories and follow removal/changing instructions as outlined in manual.
19. Use only manufacturer's recommended attachments — use of attachments not provided, approved or sold by HAAN may cause fire, electric shock or injury and will void warranty.
20. If the circuit breaker activates while using the steam function discontinue product use immediately and contact the customer support center (Beware of the risk of electrical shock.) To avoid circuit overload, do not operate another appliance on same circuit as the steam cleaner.
21. DO NOT allow the product to be disassembled and/or modified by anyone other than an authorized HAAN service technician. Doing so can result in fire and/or electrical shock and would void warranty.
22. To provide continued protection against risk of electric shock, connect to properly grounded outlet only.

Grounding Instructions:

The HAAN HS-20 must be connected to a grounded (3-prong) wiring system. Grounding provides a safe path of least resistance for electrical current, in the event the unit should malfunction or break down, thereby reducing the risk of electrical shock. The cord for this product has an equipment-grounding conductor and a grounding plug. Do not plug it into an outlet that is not properly installed and grounded in accordance with all local codes and ordinances.

Check with a qualified electrician or service person if you aren't sure if the outlet is properly grounded. If it will not fit the outlet, have a proper outlet installed by a qualified electrician. This appliance is designed for use on a nominal 120-volt circuit and has a grounding attachment plug as illustrated below. Make certain that the appliance is connected to an outlet having the same configuration as the plug. This is a safety feature — do not attempt to defeat the safety purpose of this grounding pin. No plug adapter should be used with this appliance.

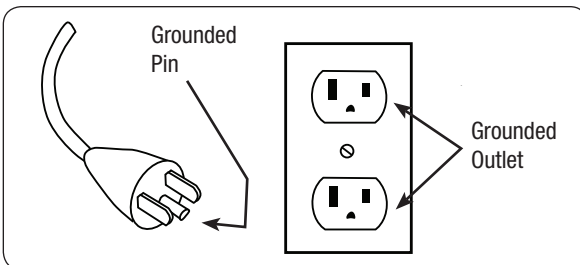

If an extension cord is absolutely necessary, an extension cord rated a minimum of 15 ampere/ 14 gauge cord should be used. Cords rated for less amperage may overheat. Care should be taken to arrange the cord so it cannot be pulled or tripped over.



Product Description



HS-20

Deluxe Personal

SANITIZING STEAM CLEANER

WITH COMPLETE ACCESSORY PACKAGE



FEATURES:

1. Main Body with Water Tank - features a stainless steel tank for durability.
2. Indicator Lights - let you know when the power is on, when the unit is ready for use and when you need to refill.
3. Double-insulated Power Cord - offers safety, protection and durability.
4. Comfort Grip Handle - has an ergonomic design for a sure grip.
5. Continuous Steam Lock - easily locks trigger in place for continuous steam — NO Pumping!
6. Easy Control Trigger - engineered for comfort and total control.



FEATURES: (cont)



7. Pressure Locking Safety Cap - virtually impossible to open until temperature and pressure levels are safe.
8. Steam Nozzle with Dual-position Easy Attachment System - lock attachments firmly into place, instantly and effortlessly.



Make sure to check for the following accessories!

9. Concentrator Nozzle - the copper-tipped head concentrates the steam for even more cleaning power. All brush and nozzle accessories attach to this for use.



10. Small Detail Brush - perfect for delicate surfaces and small nooks & crannies.



11. Large Brush - makes fast work cleaning larger surfaces and objects.

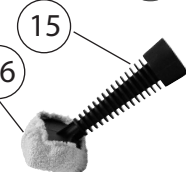

12. Steel Wool Brush Attachment - adds extra scrubbing power for surfaces that resist normal cleaning.



13. Round Wire Bristle Brush - for tough scrubbing chores, including brick or cement.



14. Angled Nozzle - gets under rims and into corners.



15. Garment/Surface Attachment - use for steaming out wrinkles in clothing, sanitizing upholstery, bedding and soft surfaces; use with cleaning sock to clean counter tops and other hard surfaces.



16. Cleaning Sock - attaches to Garment/Surface Attachment.



17. Rubber Squeegee Panel for Window Cleaning - attaches to Garment/Surface Attachment to clean mirrors and windows.

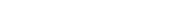

18. Extension Hose - gives you greater flexibility for a variety of cleaning tasks.



19. HAAN MicroCham™ Sponge & Towel - the innovative HAAN MicroCham™ has the cleaning power of our Ultra-Microfiber on one side and the super absorbency of our specially-developed chamois on the other.



20. Measuring Cup & Funnel- for precision filling.



21. Accessory Storage Bag - to keep the accessories handy and ready to use.



Using Your Steam Cleaner

Operating Instructions:



CAUTION

After each use, unplug the power cord and press the steam button to fully discharge all remaining air. Make sure that no steam remains before opening the safety cap.

When using this product, first perform steps 1-7 with the power cord unplugged. If using for the first time, fill with and discard water once. An odor may be emitted when first used.

Filling the Water Tank:

- 1) Press down firmly on the safety cap until you hear a clicking sound; immediately turn it counter-clockwise to remove cap. (Fig 1) Be sure that the 'Continuous Steam Lock' is in the unlock position. (Fig 2)



NOTE: After each use, completely empty any remaining water from the internal tank. Water can be drained by turning the product upside down.

- 2) Fill the measuring cup with water. Optimum capacity: 200ml. Use the funnel to fill the internal tank with water. Use only one measuring cup of water per single use. Be careful not to overflow the container. (Fig 3)
- 3) Turn the safety cap clockwise to close. The cap will continue to turn even when closed properly. During product operation, the safety cap does not open due to the internal pressure. It can be opened only when the internal pressure of the product and/or the water temperature is low.

Fig 1

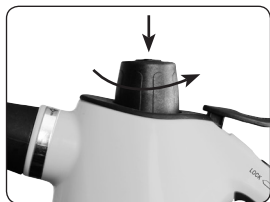

Fig 2



Fig 3



Fig 4



Attaching the Accessories:

Concentrator Nozzle, Extension Hose or Garment/Surface Attachment:

- 4) When attaching the Concentrator Nozzle, Extension Hose or Garment/Surface Attachment, align the indicator line (—) on the connection section of the accessory with the indicator line (—) on the main unit. (Fig 4) Push the accessory onto the steam nozzle of the main unit and turn in a

Fig 5



Fig 5a





Using Your Steam Cleaner



CAUTION

Never use with detergents and/or soapy water. Using the Steam Cleaner other than as recommended in this manual could damage the unit and void the warranty.

Fig 6



Fig 7



Fig 8

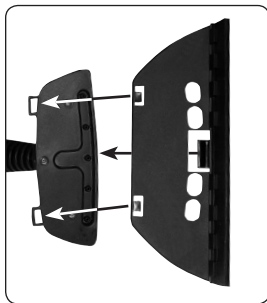

CAUTION

Do not use the Steam Cleaner on windows if they are cold. Doing so may result in the glass cracking due to the hot steam.

counter-clockwise direction until the indicator line (—) on the accessory is aligned with the double lined indicator (—) on the unit neck. (Fig 5 & 5a) This will lock the accessory in place. Make sure to affix accessories precisely as directed in instructions prior to using them.

Round Brushes (large, small & Wire Bristle) and Angled Nozzle:

- 5) Attach the Round Brushes and Angled Nozzle directly onto the end of the Concentrator Nozzle or nozzle end of the extension Hose. Press them firmly onto the tip to set them and you are ready to steam. (Fig 6)

Please use each accessory properly with regard to the item and/or location to be cleaned. Refer to "Using the Accessories" for instructions and tips for use of each.

Microfiber Cleaning Sock:

- 6) The Cleaning Sock fits snugly over the flat surface of the Garment/Surface Attachment by slipping it over one end and stretching it down and over the opposite end. The Cleaning Sock is machine washable. When cleaning sofas and/or mattresses, use the Garment/Surface Attachment with the cleaning sock attached. (Fig 7)

Rubber Squeegee Panel :

- 7) To attach the Rubber Squeegee Panel for window cleaning, first attach the Garment/Surface Attachment to the main unit or the connected Extension Hose. Be sure to remove the Cleaning Sock if it is attached. Align the connection slots at the bottom of the Garment/Surface Attachment with those at the bottom of the Rubber Squeegee Panel for window cleaning and snap them together. The tab on the underside of the Squeegee will snap onto the Garment/Surface Attachment at the same time. (Fig 8)



Using Your Steam Cleaner



CAUTION

After plugging in the power cord and beginning to heat, a fixed amount of water is released due to the build-up of internal pressure. After heating is complete, spray the steam 2 to 3 times before affixing or switching any additional attachment.

Fig 9



Fig 10

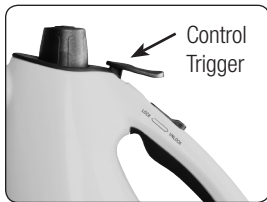
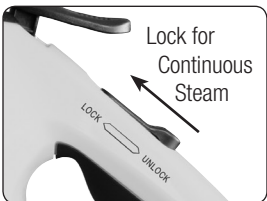

Fig 11



CAUTION

Pressure always exists within the product. Make sure to press the Control Trigger to eliminate this pressure prior to opening the safety cap.

Operating the Steam Cleaner:



NOTE: Your Steam Cleaner is designed to clean hard surfaces and upholstery that will withstand high heat. **DO NOT** use on soft plastic and cold glass. On surfaces that have been treated with wax, or on some no-wax floors, the sheen may be removed by the heat and steam action. **DO NOT** use on unsealed wood. This could cause the wood panel to rise. It is recommended that an isolated surface area be tested to verify suitability before proceeding to the rest of the area.

- 8) If using the Steam Cleaner for the first time, fill the tank and then discard this water. Refill the tank with fresh water. There may be a slight odor emitted on the first use.
- 9) Once you have attached the accessory that suits your need and filled the unit with water, plug the unit into a grounded outlet. The green 'POWER' light will come on. (Fig 9)
- 10) Wait 2-3 minutes and once the 'STEAM READY' light comes on, press the easy Control Trigger to begin steaming. (Fig 10) During use the light will turn on and off as the unit reheats to make steam.
- 11) Steam will emit from the nozzle every time the trigger is pressed and/or held down. To access continuous steam, just slide the 'Continuous Steam Lock' into the LOCKED position. (Fig 11) The steam pressure will be affected and will become low after a fixed amount of time. Use the MicroCham™ towel to absorb any surface moisture.

Refilling Water Tank During Use:

- 12) When you no longer have steam emitting from the nozzle, this signifies that there is no more water in the Water Tank. The 'STEAM READY' light will also go out when the tank is empty.
- 13) To refill the water tank, first unplug the power cord, and press the Control Trigger to fully release all steam remaining inside the tank.
- 14) Wait at least three minutes before opening the safety cap to allow the pressure to dissipate.

Operating Instructions: (cont)

When opening the safety cap, do so slowly in order to stay safe from any steam that may remain inside. Remember: the steam emitted by the Steam Cleaner is 212°F in order to sanitize; use care to avoid being burned. To open the cap, be sure that the 'Continuous Steam Lock' is in the UNLOCK position before pressing down on the cap and turning counter-clockwise after hearing the click sound.

- 15) After opening the safety cap, wait a moment and then use the funnel to add water. Use only one measuring cup of water per single use. Be careful not to overflow the container. Close the safety cap.

Tips on Using the Attachments:

Concentrator Nozzle:

- 16) This is the attachment you'll use for general steam cleaning. In the house, it's perfect for cleaning a variety of openings, window frames, shelves, tiles, blinds and more. Not only does it clean dirt away, it also kills dust mites and disinfects surfaces. In the garage or yard, it's amazing how it cleans the dirt out of wheel rims, recycling bins, garbage cans and other grimy surfaces. Try using it to steam clean sports equipment or to take away the odor in smelly athletic shoes and gym bags. (Fig 12)

Garment/Surface Attachment (with or without Cleaning Sock):

- 17) Use the Garment/Surface attachment to clean, freshen and disinfect sofas, carpets, bedding, pillows, curtains, clothing and other soft surfaces throughout your home – even pet beds and stuffed toys. (Fig 13) When used with the Cleaning Sock it removes hair and lint.

Angled Nozzle:

- 18) With the angle nozzle you can get under the toilet rim for a germ-killing clean you just can't get with a traditional toilet brush. It's also great for hard-to-reach corners and openings. (Fig 14)

Fig 12



Fig 13



Fig 14



HELPFUL HAAN HINT:

Your Cleaning Sock is machine washable. You may dry your Cleaning Sock in a machine dryer on a low setting, but for longer life, we recommend air drying.

Operating Instructions: (cont)

Tips on Using the Attachments:

Round Brushes:

Fig 15

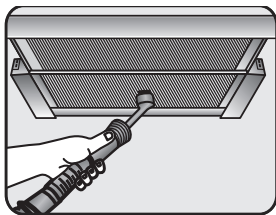

Fig 16



Fig 17



Fig 18



19) In the kitchen, the large and small round brushes are perfect for cleaning everything from gas ranges, oven racks and hoods, to sinks, counter tops and tiles. The HAAN HS-20 cleans both hardened and oily grime to make your kitchen surfaces look like new again. The round brushes are also great for sterilizing cutting boards and other kitchenware.

In the workshop or garage, try using your large round brush to clean tools, bicycles or even golf clubs. The small brush is great for steam scrubbing smaller areas or delicate items. (Fig 15)

Large Round Brush with Steel Wool:

To attach the steel wool brush attachment, simply work it into the bristles of the large brush using the palm of your hand until it is firmly attached. It's perfect for cleaning oven and grill racks or other hard surfaces that need some extra scrubbing power. (Fig 16)

Rubber Squeegee Panel:

20) Steam clean your mirrors, glass shower stalls, windows, bathroom and kitchen tiles with the rubber panel attachment. It cleans off residue and soap scum without chemicals, to leave surfaces shiny and sanitized. (Fig 17) Since the shock of the heated steam on cold glass can cause the glass to shatter, before cleaning a cold glass surface, carefully warm the glass surface by directing the steam towards the glass no closer than 4-6".

Extension Hose:

21) For added flexibility, the extension hose connects with all other accessories just like the Concentrator Nozzle. It makes it easy to clean without holding the HS-20 unit directly in front of the areas or items you are cleaning.

MicroCham™ Towel and Sponge:

22) The gentleness of a chamois cloth and the absorbency of microfiber make these unique and perfect for cleaning up spills and wiping up excess moisture left from condensing steam. (Fig 18)



Care & Maintenance



IMPORTANT

Always be sure that your Steam Cleaner is **UNPLUGGED** from the wall receptacle prior to cleaning or before emptying the water tank.



CAUTION

Do not immerse your Steam Cleaner in water or any other liquid.



HELPFUL HAAN HINT:

DO NOT use fabric softener when washing the Cleaning Sock as this will compromise the absorbency of the material.

- 1) Turn your Steam Cleaner off and unplug the unit from the electrical outlet.
 - 2) Prepare to store the Steam Cleaner by looping the power cord and fastening it with the supplied twist tie.
 - 3) After each use, unplug the power cord and press the steam button to fully discharge all remaining pressure.
 - 4) Let your Steam Cleaner cool completely before storing.
 - 5) Always empty the water tank once you have finished using your Steam Cleaner. Leaving water in the tank for long periods of time can result in the decay of the water, causing an unpleasant odor and/or black discoloration in the tank.
 - 6) Do not introduce detergents and/or soap to the water tank.
- ▶ **NOTE:** While it is acceptable to use regular tap water, if the tap water in your area is hard, we recommend you use distilled/purified water to extend the life of your product.
- 7) To clean the body of your Steam Cleaner wipe it down with a damp cloth.
 - 8) Store the unit upright in a protected dry cool area.



Troubleshooting and Questions

This chapter summarizes the most common problems you could encounter with your Steam Cleaner. Please read the different sections for more details. If you are unable to solve the problem, or have any questions not answered in this manual please contact a Customer Care Representative at 877-HAAN DIRECT (877-422-6347).



PROBLEM: Steam Cleaner does not operate.

Possible Cause:

- 1) Power cord not firmly plugged into outlet.
- 2) No power in wall outlet.

Possible Solution:

- 1) Check plug in outlet and set plug firmly.
- 2) Check fuse or breaker. Replace fuse and/or reset breaker.



PROBLEM: Steam Cleaner does not emit steam.

Possible Cause:

- 1) No water in water tank.

Possible Solution:

- 1) Add water to the water tank following the instructions on page 8.



PROBLEM: Water leaks from the nozzle of the Steam Cleaner.

Possible Cause:

- 1) There is too much water in the water tank.
- 2) The unit is not upright.
- 3) Heating has not completed its cycle

Possible Solution:

- 1) Check the amount of water in the tank. Use the supplied measuring cup and only use one (1) cupful per use.
- 2) Be sure the unit is in an upright position.
- 3) Wait until the heating cycle is complete and the red 'STEAM READY' light is lit.



PROBLEM: Steam is emitted when refilling the water tank.

Possible Cause:

- 1) The internal tank is too hot.

Possible Solution:

- 1) Wait until the unit has completely cooled.
- 2) Pour the water in slowly.
- 3) Use the funnel when refilling with water.



PROBLEM: An accessory is loose.

Possible Cause:

- 1) Accessory is not properly attached and connection is not tight.

Possible Solution:

- 1) Reattach the accessory and make sure it is tight and properly attached. Refer to the instructions for accessory attachment described starting on page 6.



QUESTION: What surfaces can be sanitized by using the Steam Cleaner?

Your Steam Cleaner is designed to clean hard surfaces like laminates & countertops, stovetops and tile, ceramic and glass as well as upholstery; any surface that will withstand high heat. It emits steam at 212°F with a fine vapor-like steam that is gentler than those that simply blast water and steam onto the surface. The HAAN is more effective at penetrating stains and killing harmful germs and bacteria than competitors. Steam is all we do, and we've spent years perfecting it.

DO NOT use on soft plastic and cold glass. On surfaces that have been treated with wax, or on some no-wax floors, the sheen may be removed by the heat and steam action. DO NOT use on unsealed wood. This could cause the wood panel to rise. It is recommended that an isolated surface area be tested to verify suitability before proceeding to the rest of the area.



QUESTION: How do I know when the HS-20 is heated up and ready to use?

When you plug the unit into your outlet, the green POWER light will come on. After about 2 or 3 minutes, the STEAM READY light will come on. Press the easy Control Trigger to begin steaming.



QUESTION: I noticed that the STEAM READY light kept going off and on while I was steaming with my HS-20. Is this normal?

That's perfectly normal. It is simply an indication of the unit reheating during use to make more steam.



QUESTION: Do I have to empty the tank completely after I'm done using it?

Yes, we recommend emptying the remaining water from the tank. Simply turn the unit upside down to drain it.



QUESTION: How long does a tank of water last?

A full tank will last approximately 15 minutes.



QUESTION: Do I have to use distilled water in my HAAN Steam Cleaner?

While it is acceptable to use regular tap water, if the tap water in your area is hard, we recommend you use distilled/purified water to extend the life of your appliance. Using hard water will shorten the life of your appliance.



QUESTION: How long can I prolong the life of my HAAN?

To maintain the life of your Steam Cleaner, we recommend using HAAN's Tank Rejuvenator (available on our web site) every six months.



QUESTION: Does the HAAN work on pet stains?

Yes, the HAAN is able to spot clean fresh pet stains by loosening and lifting the stain.



QUESTION: Will the HAAN Steam Cleaner clean grout?

Yes, but it needs a little help. If you steam the problem grout areas to loosen the grime and then scrub with one of the round brushes, it should effectively clean and sanitize your grout.



QUESTION: Why can't I open the safety cap during operation?

The high water temperature and pressure inside the tank present a safety hazard. That's why we designed this special safety cap which can only be opened when the internal pressure and/or water temperature is low.



QUESTION: Do the accessories lock into place, or do I have to worry about them coming off while I am steaming?

Yes, by aligning the indicator lines on both the accessory and the HS-20 unit, the accessory will be locked into place.



QUESTION: My new HS-20 has a funny smell when I used it the first time. Is that normal?

Yes, there may be a slight odor emitted during the first use.



QUESTION: How do I know when the tank is empty?

When there is no more steam coming from the nozzle, your water tank is empty. To refill it, first unplug the unit and press the Control Trigger to release any steam remaining in the tank. Wait at least 3 minutes before opening the safety cap to refill the tank. Resume steaming once the STEAM READY light comes on.



QUESTION: Where does the dirt go?

The HS-20 does NOT have a vacuum feature, so it does not have any suction power to pick up dirt. Be sure to vacuum or sweep up any loose dirt before using your HS-20 Steam Cleaner. The HS-20 Steam Cleaner is designed to use the power of steam to loosen dirt and thoroughly clean and sanitize while killing 99.9% of germs and bacteria. We recommend wiping the surface with the MicroCham™ towel after steaming to remove any dirt residue that was softened by the steam.

If you are trying to get out a stubborn stain, use the steam to loosen the stain then blot the area with a clean rag to remove the it.



Product Specifications: Model HS-20

Color	Mango
Size	8.5"H x 5.2"W x 8.8"D*
Weight	2.8 lbs
Voltage/Hz	12 volts / 60 Hz
Wattage	1000 watts
Cord Length	14' 9"
Tank Capacity	6.76 fluid ounces (200 ml)
Heat-up time	less than 3 minutes
Operating Time	15 minutes before refill is needed

* Base dimensions approximated. Base depth measured without nozzle or attachments.



One-Year Limited Warranty

Your HAAN Steam Cleaner is warranted to be free from defects in material and workmanship for a period of one (1) year from the date of purchase when utilized for normal household use by the original purchaser only. The included Warranty Registration Card must be filled out and returned within 10 days of purchase. This is essential for your warranty to be effective should any problem arise with this product. Should any defect covered by the terms of the limited warranty be discovered within one year, HAAN Corporation will repair or replace the defective part provided the unit is returned by the original purchaser, freight prepaid, to: HAAN Corporation, 1866 Colonial Village Lane, Lancaster, PA 17601

The liability under this warranty is limited solely to the cost of the replacement parts or the complete unit at our option. Labor charges are not included.

This warranty is extended to the original purchaser of the unit and excludes all other legal and/or conventional warranties. The responsibility of HAAN Corporation, if any, is limited to the specific obligations expressly assumed by it under the terms of the limited warranty. In no event is HAAN Corporation liable for incidental or consequential damages of any nature whatsoever. Some states/provinces do not permit the exclusion or limitation of incidental or consequential damages, so the above may not apply to you. This warranty gives you specific legal rights which vary from state to state or province to province.



IMPORTANT: Carefully pack item to avoid damage in shipping. Be sure to attach tag to item before packing with your name, complete address, and phone number with note giving purchase information, model number and what you believe is the problem with the item. We recommend you insure the package (as damage in shipping is not covered by our warranty). Mark the outside of your package "ATTENTION CUSTOMER SERVICE." We are constantly striving to improve our products; therefore, the specifications contained herein are subject to change without notice.

Don't miss out on all the benefits that come with registration.
Go to www.HAANUSA.com/register; call or mail this completed form today.

Product Registration

HAAN

engineering clean.

Please fill out and mail this Product Registration Card within ten (10) days of purchase. In order to validate the aforesaid Limited Warranty. The registration will allow us to contact you in the unlikely event of a product safety notification. By returning this card you acknowledge that you have read and understood the instructions for use and the warnings set forth within the instructions.

First Name _____ Last Name _____

Address _____

City _____ State/Province _____

Zip Code / Postal Code _____ Country / Territory _____

Product Name / Model Number _____

Date Purchased _____ Place of Purchase _____

(Fold here and tape closed before mailing)

Warranty Notice: FAILURE TO COMPLETE AND RETURN THIS PRODUCT REGISTRATION CARD WILL NOT DIMINISH YOUR WARRANTY RIGHTS.

Privacy Notice: We use this information requested on this card to process your registration, thereby allowing you to receive the benefits of being a registered user, and for use in post-sales services. Other uses of your information are governed by the choices you make in answering the questions and the HAAN privacy policy. For information on this policy contact 877-HAAN Direct.

1) Yes! I would like HAAN to send me information on products and services including new product releases, events and special offers. You may contact me by:

email _____

phone _____

mail _____

2) What other HAAN products have you purchased?

Cut along dashed line

HAAN

engineering clean.™

Place
Stamp
Here

Product Registration
HAAN Corporation
1866 Colonial Village Lane
Lancaster, PA 17601

3) Where did you purchase your HAAN product?

4) How did you hear about HAAN?

5) We like to hear from our product owners. Please add any comments here:

