

New Tools from B&G for Insecticide Application



a Pelsis Group Brand  pelsis

2019



Pressurizing Tank Top

Maintains optimal pressure in tank



Treatment-Volume Meter

Measures amount applied in each account



Next Generation Valve

Stainless steel + polymer valve and brass nozzle

Pressurizing Tank Top

Optimal pressure and
flow rate for the nozzle

Fits all B&G stainless
steel sprayers

1 lb. less than the
brass pump system



'Head Space'

The **air space** above the liquid in the tank that is pressurized to...

...this pressure forces liquid into the siphon tube and through the hose to the nozzle

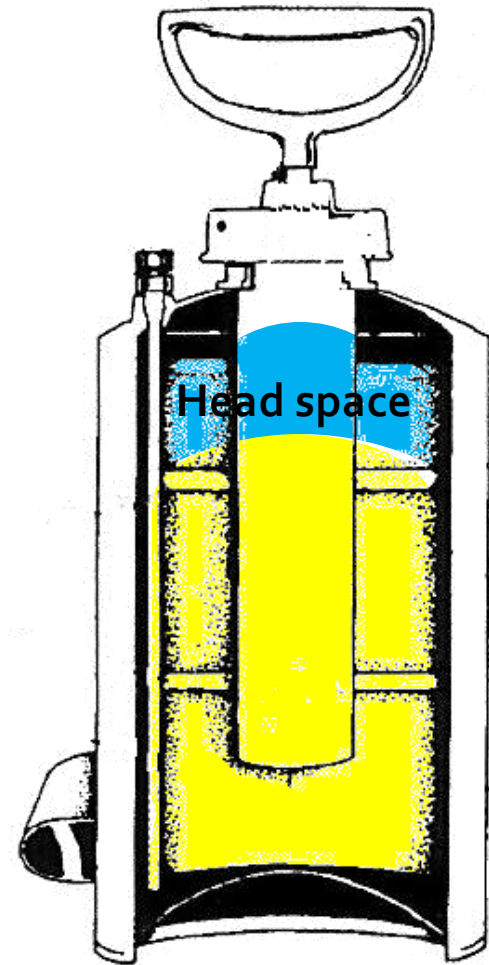

Pressurizing the Tank

- **Pressurize** tank to 30 psi with 20 - 25 strokes
- More pressure in tank is not worth the back strain...there's no advantage



Spraying Pressure Loss

Tank pressurized by technician to **30 psi**

After spraying 30 seconds tank pressure = **23 - 25 psi**

Spraying 30 seconds more tank pressure = **18 - 20 psi**

**20 - 25 strokes bring
back to 30 psi**

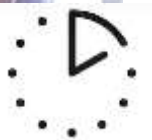

Pressure...Flow rate... ...Spray pattern

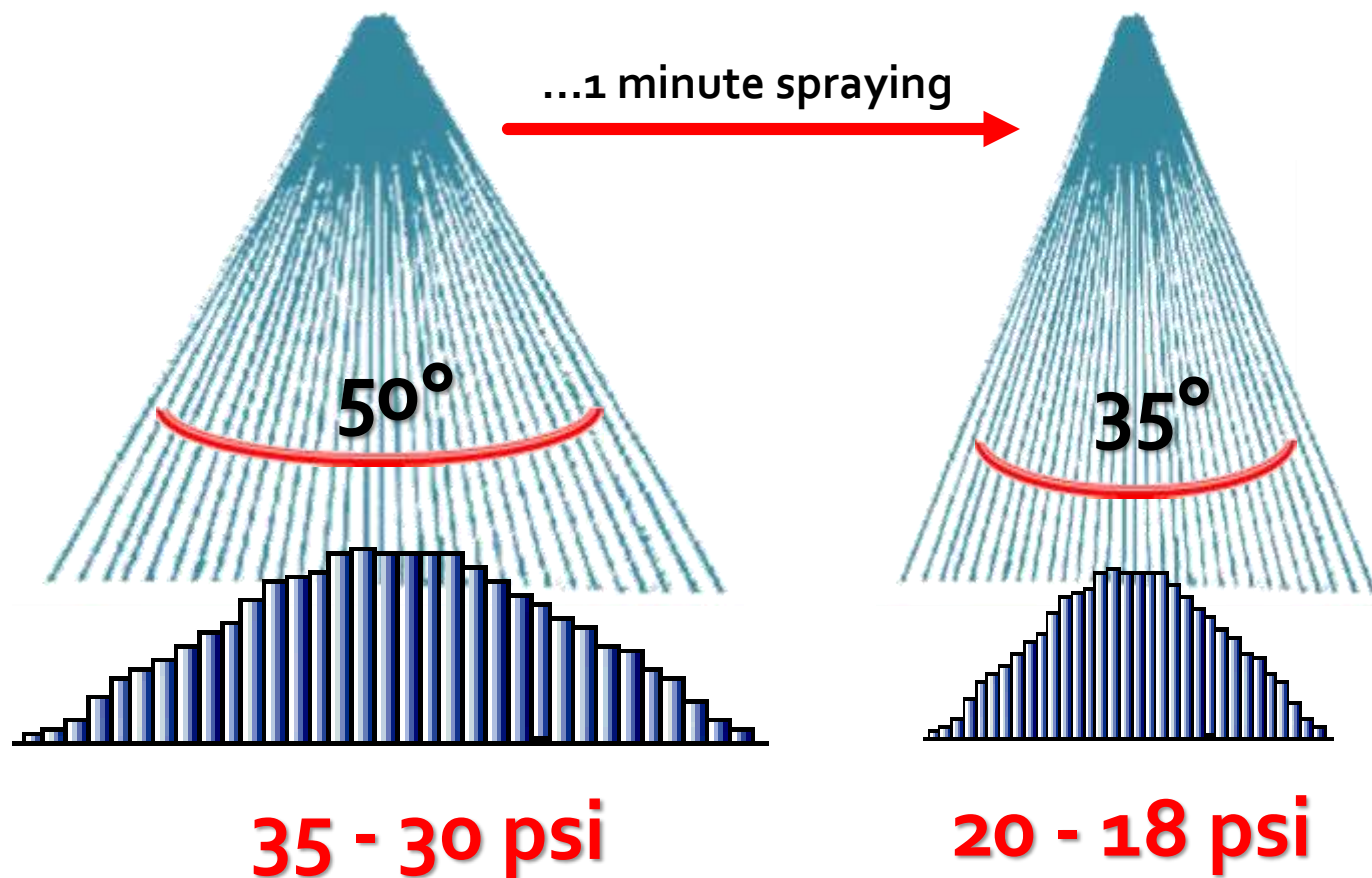

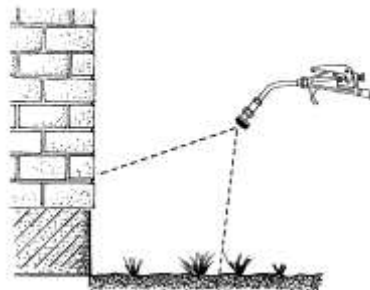
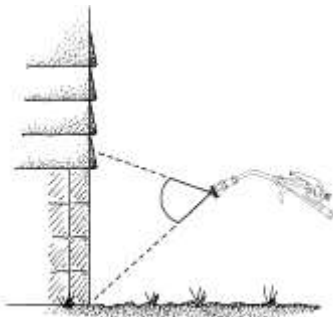
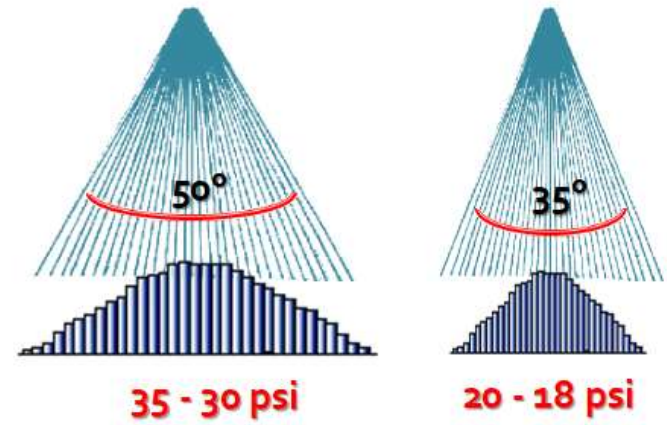

28 - 33 psi

Pump turns on: 28 psi

Pump turns off: 33 psi

2 minutes

to pressurize at filling

Delivers 30 gallons
with full battery charge



Pump maintains
average tank
pressure of
30 psi

**Controlled pressure
and flow rate
Consistent spray pattern**

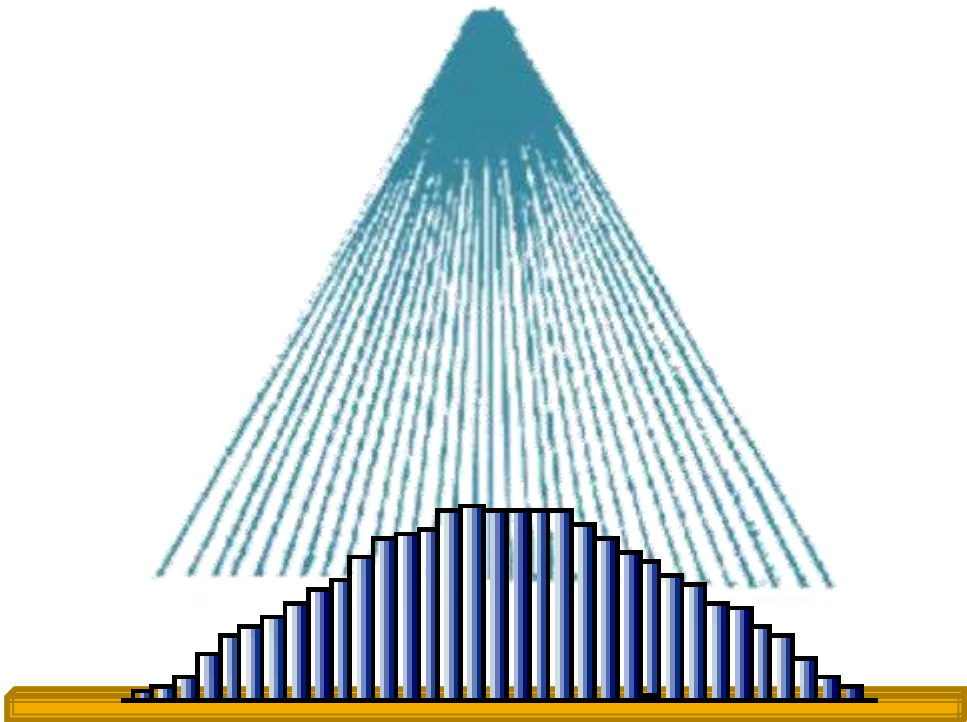

...uniform residue = control...



**Coarse fan
flow rate:
17 oz. / min
at 30 psi**

Screws onto a B&G
tank with **2 ½ turns**

...more than 2 ½ turns
tank gasket is missing
...replace it



#22050100

Gasket in
GD-124
Repair Kit



#22028000



Underside
of PTT

Charging done on or off tank



Charges in **4 hrs.**



Battery Replacement

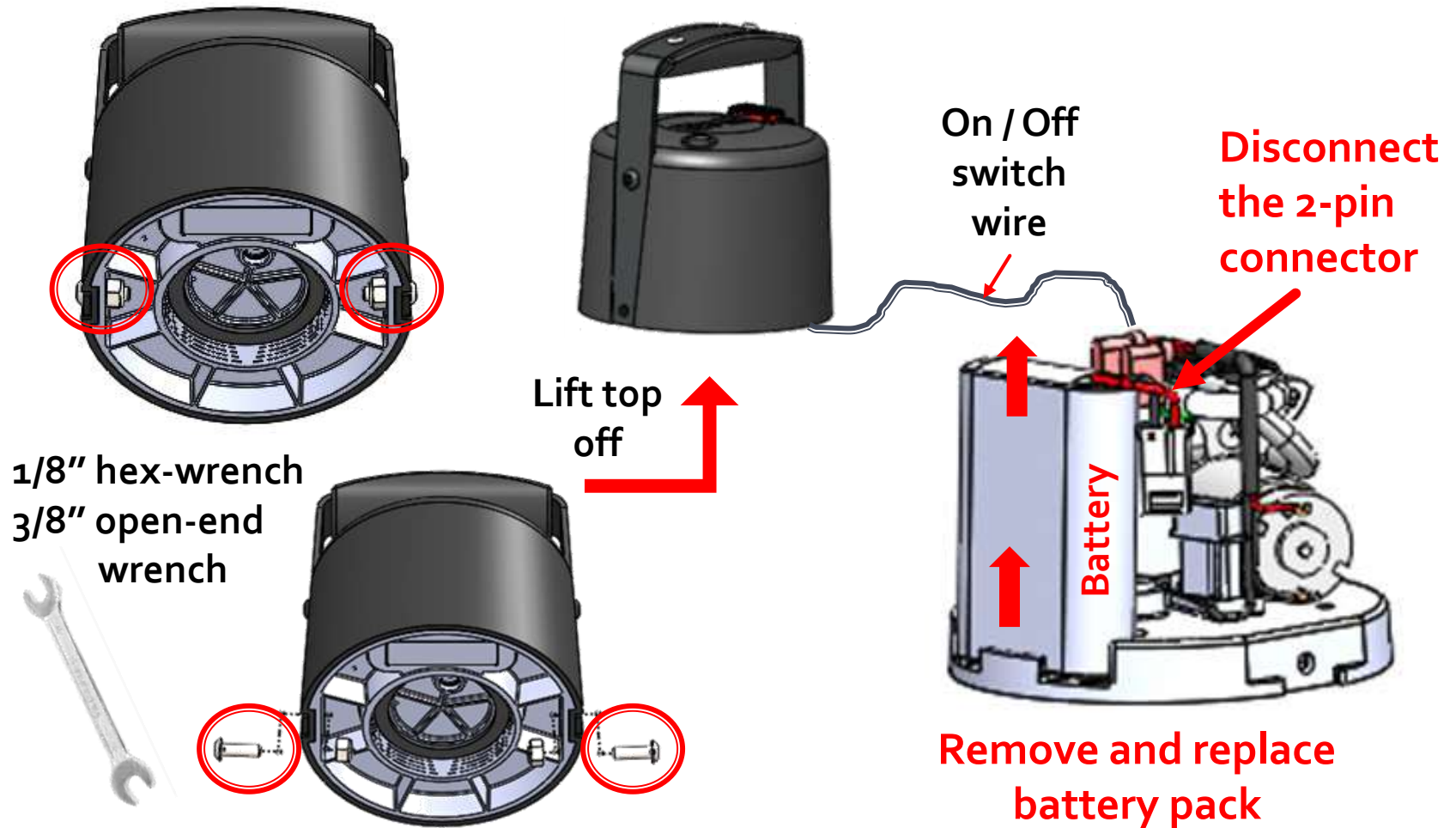

Time Savings



Time
pumping
6.5 min.

Time
spraying
7.5 min.

Total
14 min.

14 min.
to empty tank



Time
pumping
--none--

Time
spraying
7.5 min.

Total
7.5 min.

7.5 min.
to empty tank



Pressurizing Tank Top ***more than no pumping***

...less treatment time

***...improves nozzle
spray pattern***

...better control



Order # 22046000

Treatment-Volume Meter

Measures the ounces
applied during each
treatment...

Date, time and amount
saved and sent
to a phone App
or computer



- Turns 360°
- **1-wk** battery
- **2 hr.** recharge

Line
indicates
meter is
measuring



Mechanics



**No moving parts
Will not clog**

**Works with all
formulations**

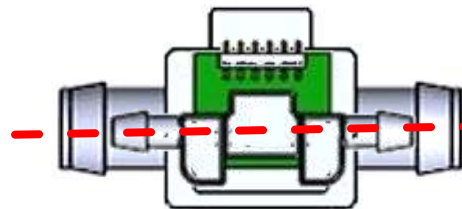

Digital chip measures
temperature change
of liquid going through

Operation



**Press button
to turn On**

Screen shows
charge in battery
and **0.0 °Z**

Press - hold
button to start
measuring



Amount applied
shown during
treatment



...hold...

Push + hold to
end measuring



...hold...

Push + hold to
clear for next
treatment

Recording Application



Push + hold at
start of treatment



Push + hold at
end of treatment



Push + hold to **clear**
Push + hold to **start**
new treatment

Record by **hand** and/or **phone App**

Change oz. to ml



press + hold button
when charger is
connected

Battery Charging



Battery charges
in **2 hours** ...

Re-charge when
power bar at 20%

Sprayer Nozzle

*Coarse
fan*



Accuracy of the Meter
depends on wear of the
sprayer nozzle...

Evaluate nozzle with a
1 min. spray at 30 psi



Monitor Nozzle Wear



Coarse fan



10% wear

1 minute spray

A nozzle with
10% wear is
over-applying
product...



8004 fan



10% wear

15 second spray

**Wasting
money**

**Violating
label**

Spray Time / Amount



Coarse fan spray

30 seconds - **8.3 oz.**
1 minute - **17 oz.**
2 minutes - **34 oz.**



White straw

30 seconds - **2 oz.**
1 minute - **3.8 oz.**
2 minutes - **7 oz.**



Red straw

30 seconds - **3 oz.**
1 minute - **6 oz.**
2 minutes - **12 oz.**



Determine Spray Time

Coarse fan



C+C straw



Divide amount by
17 = spray time



1 minute spray time

Divide amount by
3.8 = spray time



2 minutes spray time

Amount Applied



***Coarse
fan spray***

10.3 oz. decrease



As control improves, **amount sprayed** at monthly service decreases.

Meter can document the change.

Time Spraying



**C+C
straw**

(5 min. - 2 min.)
3 minute decrease



As control improves, **spray time** during monthly service decreases.

Meter can document the change.

**Treatment-Volume
Meter *more than
measuring amount
applied...***

***...reduces costs
...improves training
...improves control***



Order # 22046810

Next Generation Valve

Next Gen Valve

stainless steel core
stainless steel extension
...and brass nozzle

High-density polymer grip
makes it light-weight and durable

...weighs about 1/3 less than Extenda-ban...

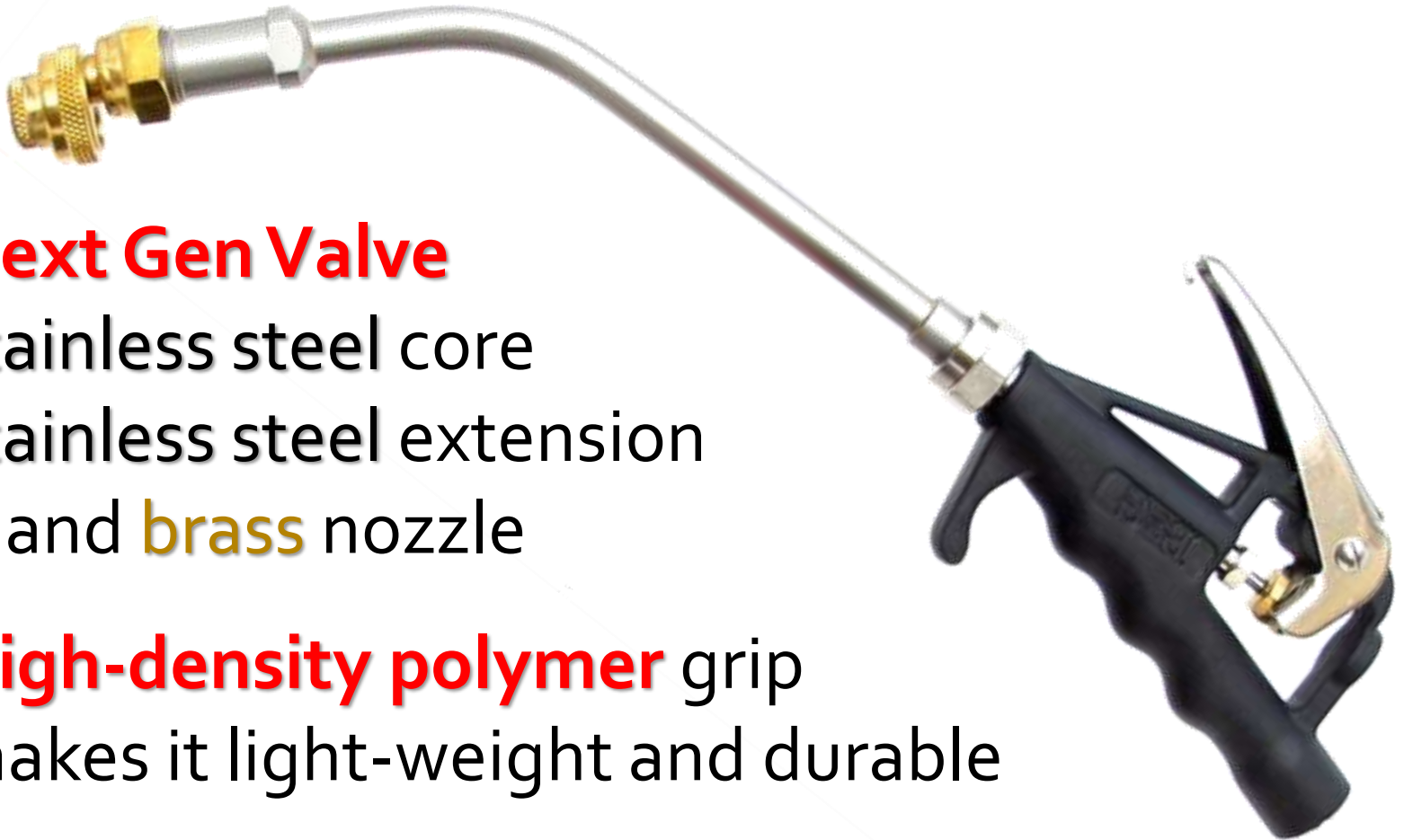



Brass nozzle assembly
will take the standard
4-way or the 4-way C+C



4-Way C+C



4-Way

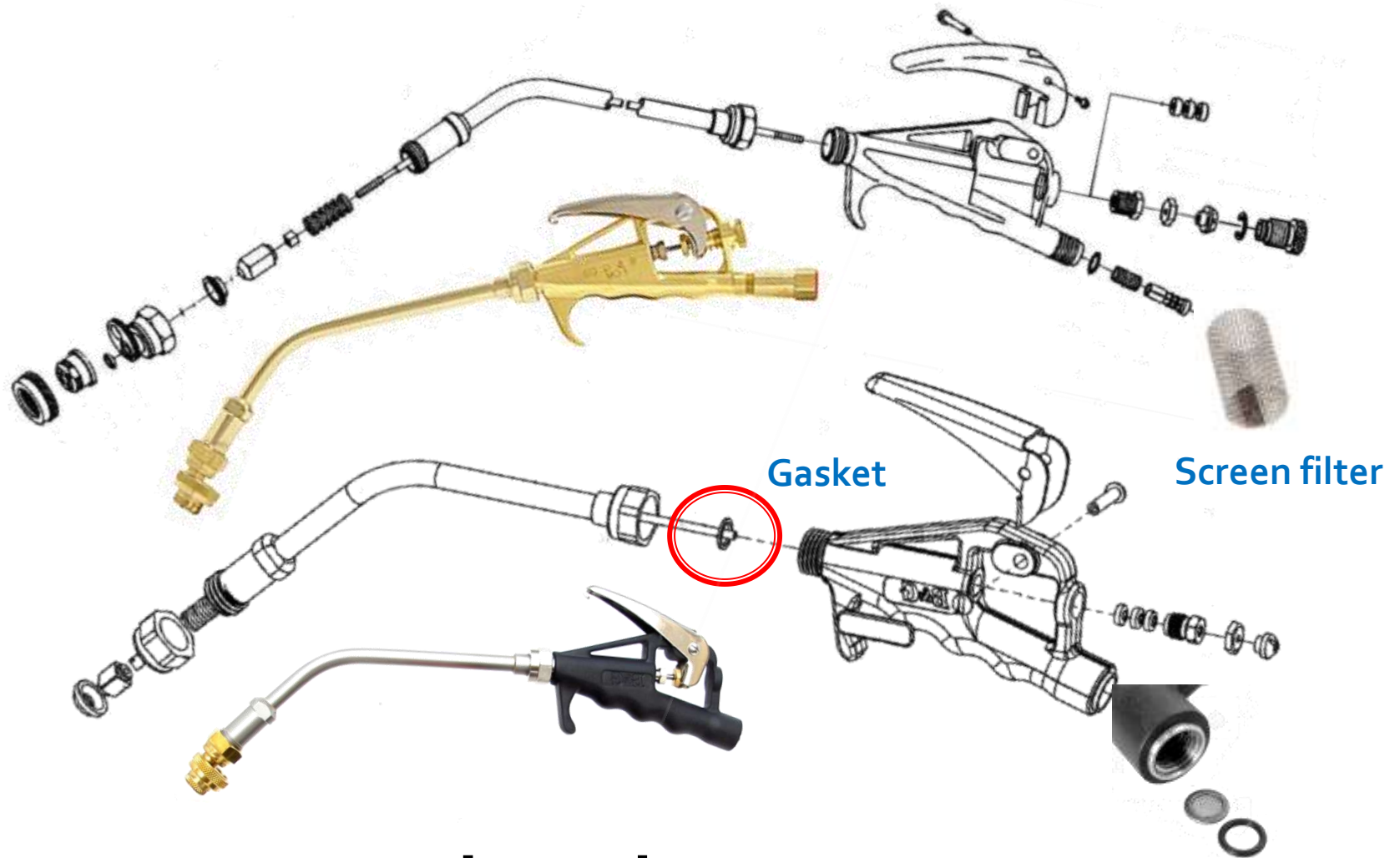

**Repair and parts same
as Extenda-a ban Valve**

Next Generation Valve

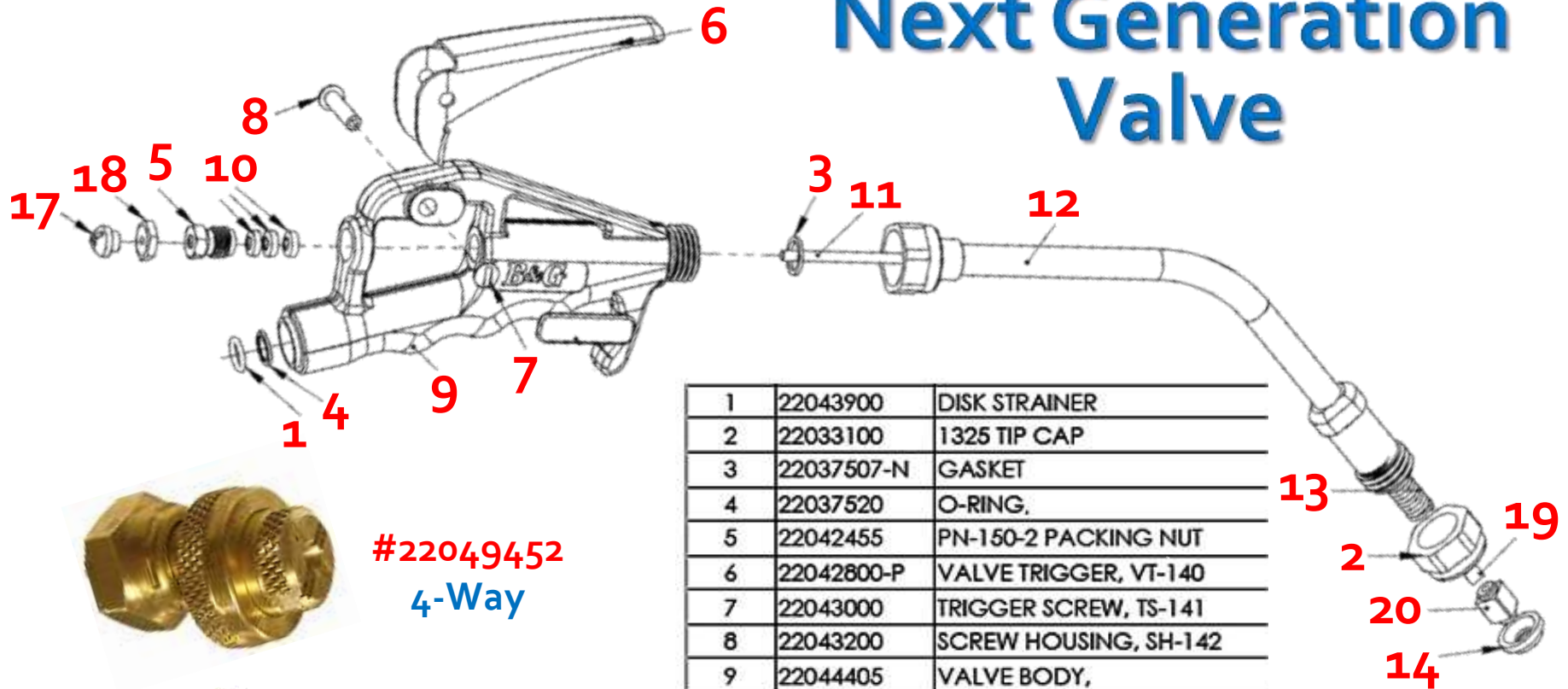

#22049452
4-Way



#22049467
4-Way C+C

1	22043900	DISK STRAINER
2	22033100	1325 TIP CAP
3	22037507-N	GASKET
4	22037520	O-RING,
5	22042455	PN-150-2 PACKING NUT
6	22042800-P	VALVE TRIGGER, VT-140
7	22043000	TRIGGER SCREW, TS-141
8	22043200	SCREW HOUSING, SH-142
9	22044405	VALVE BODY,
10	220445099	VP-151 VALVE PACKING
11	22055446	2206 Shutoff Stem ASY
11	22045400	VC-153 VALVE CABLE 18"
11	22045450	VC-163 VALVE CABLE 24"
11	22045300	VC-152 VALVE CABLE 8"
12	22045610	VE-155 18" Tube AY
12	22045710	VE-164 24" TUBE AY
12	22045510	VE-154 8" TUBE AY
13	22045700	VS-156 VALVE SPRING
14	22046300	SP-159 VITON SEAT GASKET
14	22046350	SP-159-01 PTFE SEAT GASKET

17	P-22044500	AS-148, ADJUSTMENT SCREW
18	P-22044700	CABLE LOCK NUT
19	P-22045900	SQUARE NUT
20	P-22046100	SHUT OFF TIP

Next Generation Valve
more than just a new
Extenda-ban...

...all stainless steel
...no-slip grip / handle
...less weight



Order # 22042301 - 9 in.

Order # 22042401 - 18 in.

New Tools from B&G for Insecticide Application



a Pelsis Group Brand  pelsis