



R.T.U. SILVERFISH TRAP



SMART DESIGN MAKES TRAPPING SILVERFISH EASY!

ALSO TRAPS OTHER INSECTS & LARVAE THAT DAMAGE BOOKS, LIBRARY & MUSEUM COLLECTIONS

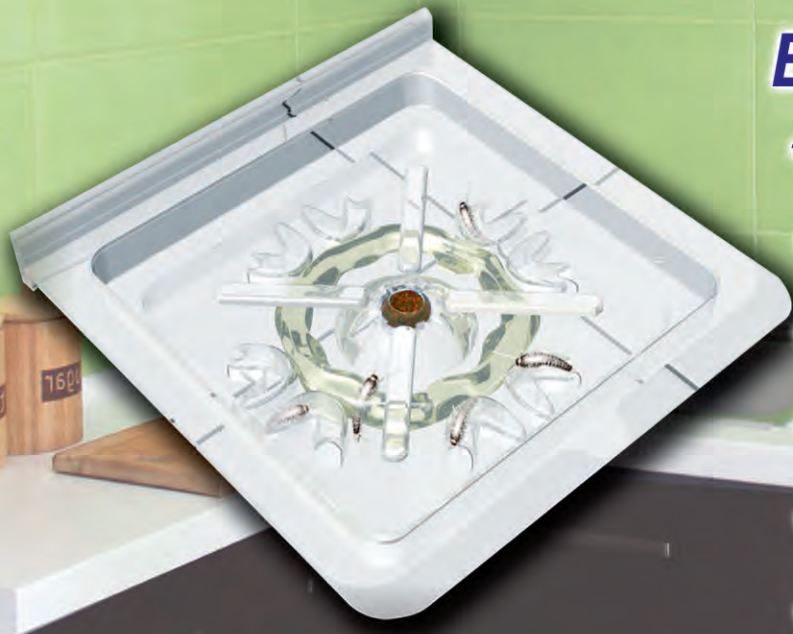

EFFECTIVE FOR:

- * SILVERFISH
- * FIRE BRATS
- * MUSEUM BEETLE LARVAE
- * BROWN CARPET BEETLE LARVAE
- * PSOCOPTERA
- * DRUGSTORE BEETLES



Easy to Use:

1. Remove food attractant from packaging. Open trap & place food attractant in the bottom, center of the trap **.
2. Close the trap.
3. Place the trap on a smooth surface (Do not place trap on carpets/carpet flooring).
4. Replace trap as needed.

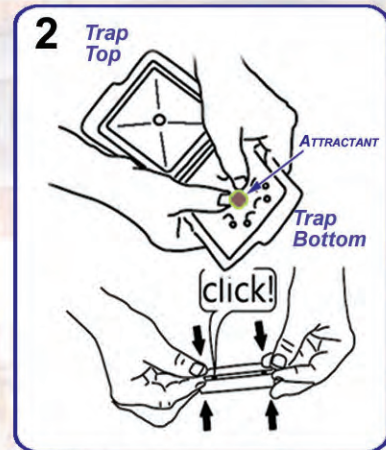
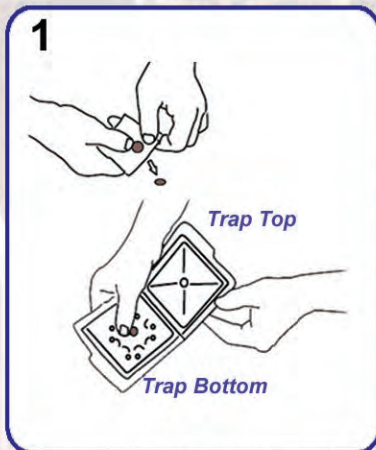

****Important! Bottom side of trap has the 8 tunnel grooves**

Top of the trap has the large "X" groove.



No Insecticide

Food attractant does not contain any harmful ingredients.
Safe for humans and pets :-)





R. T. U. SILVERFISH TRAP



R. T. U. Silverfish Trap with Food Attractant

Item #	Description	Package Size	Wt.
63-10004	Silverfish Traps 4.5" x 4.5"	Display box: 12-2 packs, trap with food attractant Box size: 9"L x 5"W x 5"H	1.11 lbs
63-10005	Silverfish Traps 4.5" x 4.5"	Bulk packed: 12 traps & 12 food attractant Box size: 5"L x 5"W x 4"H	0.50 lbs
63-10006	Silverfish Traps 4.5" x 4.5"	Master case: 12 bx-12 traps w/food attractant bulk Box size: 16"L x 11"W x 9"H	6.80 lbs
63-10008	Silverfish Traps 4.5" x 4.5"	100 - 2packs/box, trap with food attractant Box size: 18"L x 10"W x 10"H	7.50 lbs
63-10009	Silverfish Traps 4.5" x 4.5"	Bulk packed: 300 traps with food attractant Box size: 22"L x 12"W x 10"H	8.60 lbs



Individually wrapped attractants

